



Ripmax

NEW ITEMS 2011



**Hundreds of
Exciting New
Products Inside!**



For the latest information, prices and specifications of your favourite modelling products, it's got to be www.ripmax.com!

Packed with over 20,000 items, it is the definitive collection of the finest products from around the world. It's all here... from the smallest spare part to aircraft, helicopters, cars, rockets, engines, field equipment, motors, speed controllers, props, batteries, chargers, radios, tools and much, much more! Updated daily, with more and more content every week, it really is the first place you need to visit on the web.

www.ripmax.com

Ripmax

CONTENTS

Aircraft.....	1~24
Helicopters	10 & 20
Simulators.....	16
Boats	24~29
Cars	30~35
Engines.....	36~39
Batteries & Chargers.....	39~41
Speed Controllers	42~43
Micro Digital Video Camera.....	43
Futaba Radio & Accessories	44~51
Saturn Radio & Accessories	52~53
New Power Servos.....	54
Materials	55
Flying Legends P-51 Mustang.....	56

NEW ITEMS 2011

NOTE: Unless clearly identified as 'Included' in the specifications table, all models are supplied without radio and power system (i.e. engine or motor) and require further items to complete. We may offer recommendations as to suitable motors, engines and radios for the models we are featuring but these are not included. Most of the models shown are supplied Almost Ready to Fly or operate and only require final assembly. For further information see www.ripmax.com

E&OE. Whilst every effort has been made to guarantee the accuracy of this publication, it is inevitable that some errors may occur during its production. Ripmax Ltd can accept no responsibility for losses or damages caused. Prices shown are intended as a guide only. Please check with your local dealer for current prices.

SPACEWALKER 120 ARTF

A large version of this classic aircraft, designed to accept .91 -1.20 size four stroke engines. This is the two seat version compared to the smaller Black Horse Spacewalker launched some months ago.

A simple to assemble model covered in Oracover that is both scale and sport at the same time. Ideal for the average club field with her predictable handling and short take-offs and landings. The tough aluminium undercarriage will soak up a tremendous amount of rough ground and come back for more.

The wings dismantle for easy transportation.



Wingspan:	2100mm (82.68")
Length:	1500mm (59.06")
Engine:	.91 2-stroke or 1.20 4-stroke
Radio:	4 Channel
Servos:	5 Servos

A-BH078 Black Horse Spacewalker 120 ARTF..... £269.99

PILATUS PC-9 ARTF

Wingspan:	1550mm (61.02")
Length:	1580mm (62.2")
Engine:	.61 2-stroke, .91 4-stroke
Radio:	6 Channel
Servos:	8 Servos

A great addition to the Black Horse range is this beautifully built Pilatus PC-9. Offering sensational flight performance with popular .61 – .91 size engines, the PC-9 features all-wood construction, functioning flaps, factory painted fibreglass cowling with scale exhaust detailing and a crystal clear canopy. Hand finished in durable Oracover to this exciting and easy-to track scheme and includes a custom set of quality air operated retracts!

**Air
Operated
Retracts
Included!**

Functioning Flaps!



A-BH079 Black Horse Pilatus PC-9 61 ARTF..... £329.99

JU-87B-2 STUKA ARTF

Very few aircraft can be truly said to strike terror in a population more than the Stuka. Designed primarily for a 1.20 size four stroke engine, the Stuka can also be converted to EP power if preferred.

Those characteristic ailerons and flaps work just like the real thing and are surprisingly effective. The sprung undercarriage absorbs the bumps on the average flying field very well. Each wing, complete with undercarriage leg, can be removed for transport.

Wingspan:	1920mm (76.5")
Length:	1560mm (61.4")
Engine:	.91 2-stroke, 1.20 4-stroke
Radio:	6 Channel
Servos:	8 Servos

A-BH080 Black Horse Ju-87B-2 Stuka ARTF..... £249.99



MIDGET MUSTANG EP ARTF

Modelled on one of the most famous post war racing aircraft, the Black Horse Midget Mustang EP will turn heads wherever she flies. That stunning red and yellow colour scheme is both pretty and functional by making visibility good at most attitudes.

Just add a KMS 2820/05 motor and a 3 cell 2200mAh Intellect Li-Po for strong racing performance without busting your bank balance.

It will certainly get your adrenaline flowing!!

Wingspan:	1000mm (39.37")
Length:	860mm (33.86")
Motor:	KMS Quantum 2820/05
Radio:	4 Channel
Servos:	3 Mini Servos
Battery:	3S 2200mAh 20C LiPo



**Legendary
Reno Racer!**

A-BH081 Black Horse Midget Mustang EP ARTF.....£132.99

BIRD DOG ARTF

A beautiful and charismatic aircraft, accurately reproduced by Black Horse in semi-scale format. Suitable for .81-.91 size four stroke engines or a .61 two stroke and 5 channel R/C.

Like the original, the model has very docile handling characteristics and good STOL capability, thanks to the highly effective flaps.

Construction is from laser cut balsa and ply parts that are factory assembled and hand finished. That attractive grey colour scheme comes courtesy of durable Oracover film. The wings can be removed for easy transport.

A light aircraft with a difference!



Wingspan:	1890mm (74.41")
Length:	1400mm (55.12")
Engine:	.55 2-stroke, .91 4-stroke
Radio:	5 Channel
Servos:	7 Servos

**Large 74"
Span!**

A-BH082 Black Horse Bird Dog ARTF..... £209.99

MIDGET MUSTANG 61 ARTF

A bigger version of the classic 'Reno' style racer that looks fast just sitting on the ground.

In the air, the Midget Mustang has a surprising turn of speed with a .61 two stroke up front, but the low wing loading means that she can be operated from fairly small club patches. The tough aluminium undercarriage is intended to cope with grass fields and landings and take-offs can be performed in a very short distance. This is more than ably assisted by the effective flaps.

The complex cowl and cheeks of the Midget Mustang are all moulded from GRP in one piece. What a work of moulding art!! It's almost criminal to cut holes for the engine in it.

Encourage a clubmate to buy one as well and you really can be racing!!!

A-BH083 Black Horse Midget Mustang 61 ARTF..... £169.99



Wingspan:	1450mm (57.09")
Length:	1200mm (52.36")
Engine:	.91 2-stroke, 1.20 4-stroke
Radio:	6 Channel
Servos:	8 Servos

**Fibreglass
Cowl!**

WILD HOTS ARTF

Wild and Fun,
that's what the
Wild Hots ARTF is
all about!

Always intended as
an all out aerobatic
model for the most
demanding pilot, the
Wild Hots can be as tame or as
wild as you like. The key is in the radio setup as
there are no limitations with this model. Factory built
from laser cut balsa and ply parts then covered in
Oracover for a durable, long-lasting finish.

Get into the radical world, try a Wild Hots!

A-BH084 Black Horse Wild Hots ARTF.....£144.99

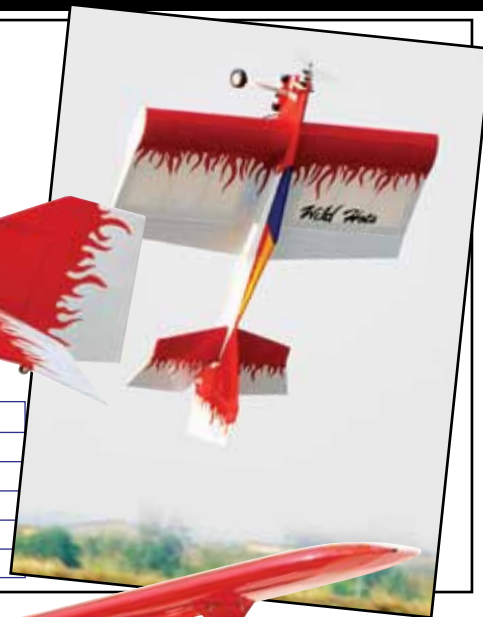

Wingspan:	1020mm (40.16")
Length:	1190mm (46.85")
Motor:	KMS Quantum 2820/06
Radio:	4 Channel
Servos:	4 Mini Servos
Battery:	3S 2200mAh LiPo

**PITTS SPECIAL ARTF**

The Pitts Special is well known for
its aerobatic prowess and the Black
Horse version is more than up to
that demand. Compact and light, the
recommended 1.20 four stroke engine
will haul her around the sky with ease.
The attention to weight in the design
ensures that low speed handling is far
better than you would expect for this kind
of model.

Accurately constructed throughout in Laser
cut balsa and ply and then expertly covered in Oracover at
the Black Horse factory. Black Horse have built up an enviable
reputation for construction quality. Even the most complex of
curves have been reproduced. The durable GRP cowl and complete
set of hardware makes this Pitts very 'Special'!

A-BH085 Black Horse Pitts Special ARTF £259.99

**Highly
Aerobatic!**



Wingspan:	1500mm (59.06")
Length:	1330mm (52.36")
Engine:	.91 2-stroke, 1.20 4-stroke
Radio:	6 Channel
Servos:	8 Servos

**SONIC EP ARTF**

The first electric glider from Black Horse had to be
something special, and the Sonic certainly is!

Although sleek and with more than a passing
resemblance to the 'hotliner' concept, the Sonic
is actually far more sports flyer orientated. The
suggested KMS motor will provide a great climb
performance although not vertical. Where the Sonic
wins is the docile yet crisp handling with no nasty
surprises. The design is intended to be flown at a
more positive speed rather than just floated around
and that rewards with an efficient glide ratio. It is a
model that will feel comfortable to a pilot used to
sports I.C. models in terms of handling yet with the
right conditions will happily thermal all day.

Construction is all wood and covered in Oracover film.

A-BH086 Black Horse Sonic EP ARTF.....£159.99

Wingspan:	2000mm (78.34")
Length:	990mm (38.98")
Motor:	KMS Quantum 2814/09
Radio:	4 Channel
Servos:	3 Servos
Battery:	3S 2100mAh 20C

Supplied in a sturdy,
laser-cut, wooden
carrying case!



FW-190A ARTF

The famous Luftwaffe 'Butcher Bird' is lovingly recreated by Black Horse to look and behave just like the full size! The FW-190 was famous for its great performance and ease of handling, and this model will not disappoint. That wide-track, air retracting undercarriage (supplied) together with a careful choice of wing section and tail areas guarantee the most docile of manners at all speeds. Crank up the power from a good 1.20 four stroke like the O.S. FS-120S-E and you are ready to dogfight those Spitfires!!

When it's time to land, the split flaps are effective and predictable, taking the trauma out of landing a scale warbird.

As a first WWII fighter, the Black Horse FW-190A is hard to beat! The choice of glow or EP power is up to you.

Wingspan:	1500mm (59.06")
Length:	1330mm (52.36")
Engine:	.91 2-stroke, 1.20 4-stroke
Radio:	6 Channel
Servos:	8 Servos

A-BH087 Black Horse FW-190A.....£TBA



MINIMOIA ARTF



Massive 133" Wingspan!



Wingspan:	3400mm (133.86")
Length:	1340mm (52.76")
Weight:	200g (4.4lb)
Radio:	5 Channel
Servos:	7 Servos

The Minimoia is one of the most iconic gliders ever made. Every glider pilot has heard of it and most are captivated by its simple beauty. Black Horse have faithfully re-created those famous bird-like curves and followed the design closely. The Minimoia is not a simple model, but Black Horse have never been worried about tackling tricky subjects. At 3.4m span, the Minimoia is no small model. She can be flown from the slope or aerotowed from the built-in tow release. The Minimoia is totally hand built on jigs by skilled staff from laser cut balsa and plywood parts, then covered in a stunning scale Swiss scheme to aid visibility at altitude.

Transportation is a doddle, thanks to the simple dismantling nature of the design and the supplied, wooden transport case.

A-BH088 Black Horse Minimoia ARTF.....£TBA

COMMANDER EP ARTF

If you want to emulate Bob Hoover, the famous US demonstration/test pilot, you will need a good model of the famous twin-engine Commander to do it with! The Black Horse Commander offers the same swooping lines that the real Commander is famous for and most of the flying characteristics too. Ok, there's not quite the mass and inertia to do his famous engine off routine but with a lot less wing loading, the risk of low speed stalling is much lower too. That's one of the advantages of careful design and lightweight, CAD/laser cut parts.

The fixed, tricycle undercarriage is sturdy and well suited to UK flying fields. That high wing provides great lift and stability, as well as docile stalling characteristics, and makes the Black Horse Commander an ideal first twin.

Wingspan:	1460mm (57.48")
Length:	1020mm (40.16")
Motor:	2808/24 (x2)
Radio:	4 Channel
Servos:	4 Servos

A-BH089 Black Horse Commander EP ARTF.....£TBA



COMMANDER GP

Similar in overall shape to the EP version, the Commander GP is so much more than a scaled up sibling. The construction is still from laser cut balsa and ply parts, hand assembled by skilled factory staff, there is just that much more of it. This version is primarily designed to be powered by .46 size 2-stroke glow engines but .52 size four strokes or even an electric conversion are possible options. Cowlings are GRP and the beautiful covering comes courtesy of Oracover. Just like the real Commander, the main retract units are twist-and-turn type and tuck away neatly into the nacelles. Being a fairly large model, the wings are removable for transport, making the Commander GP easy to transport.

Ready to try that Bob Hoover aerobatic routine??

Wingspan:	2060mm (81.10")
Length:	1460mm (57.48")
Engine:	(2x) .46 2-stroke or .52 4-stroke
Radio:	6 Channel
Servos:	9 Servos

A-BH090 **Black Horse Commander GP £TBA**

**ZIVKO EDGE 540V3 .91 ARTF**

The Red Bull air race series concentrated the designs of many aerobatic aircraft into a combination of speed and agility. A few went that extra mile and added true beauty as well. The Edge 540V3 is one such aircraft!

The Edge 540V3 is a design with many curves to it and Black Horse are the masters of complex curves and wooden construction. The sleek fuselage blends into both the racing canopy and cowling alike to limit drag as much as possible. The wing section has been chosen to give both high speed and high G stability, making the Edge 540V3 a joy to fly without any nasty tendencies. Those up-swept wing tips go a long way to reducing the tip stalling usually present in such aircraft, and to cap it all, they look sexy too!

A-BH091 **Black Horse Zivko Edge 540V3 .91 ARTF £TBA**



Wingspan:	1610mm (63.39")
Length:	1290mm (50.79")
Engine:	.91 4-stroke
Radio:	4 Channel
Servos:	5 Servos

ZIVKO EDGE 540V3 50CC ARTF

There are a lot of 50cc size aerobatic models on the market these days, but none come close to the Black Horse Edge 540V3 for looks and performance. This Edge 540V3 has been totally engineered with the discerning aerobatic modeller in mind. Every aspect of the CAD design has been thought carefully through to give strength where it is needed and reduce weight where it is not. The removable wings locate with two large, tubular, aluminium spars to provide both strength and security. Each aileron has twin servos and pushrods for real control power. All linkages, both in the fuselage and wing, are heavy duty. The large, GRP cowling will swallow most 50cc engines and the fuselage has been designed to accept an internal in-line silencer if required. The undercarriage is a heavy duty, double-aluminium plate system, that provides both strength and shock absorption. Spats are of course GRP. Flight performance? In a word... awesome!!

Wingspan:	2286mm (90")
Length:	1806mm (71.10")
Engine:	55cc Petrol
Radio:	6 Channel
Servos:	8 Servos

A-BH092 **Black Horse Zivko Edge 540V3 50cc ARTF £TBA**



EDGE 85cc

540-V3



Massive 105" Wingspan!

Working on the adage that 'biggest is best', Black Horse decided that their gorgeous Edge 540V3 should grow just that little bit more from 50cc to an 85cc version. The GRP cowling will accept both twin and single cylinder petrol engines with ease to give you an impressive model on the ground and in the air. At 2.68m span she certainly has a 'presence'!! Like the 50cc sibling, this model is built from Laser cut ply and balsa parts and then lovingly covered in a stunning scheme of Oracover heat shrink film. All mouldings are GRP yet she barely reaches 11.5kg all up. To fly well, weight has to be minimised, and Black Horse have gone the extra mile achieving that. All the hardware is heavy duty and been optimised for the loads that such a model creates. With removable wings and tail, the edge will fit in a reasonable estate car or a hatchback. It's hard to imagine a better combination of beauty and quality in a traditional wooden model, and to cap it all she's big and impressive too!

Wingspan:	2680mm (105.51")	Engine:	80-85cc Petrol
Length:	2150mm (84.65")	Radio:	8 Channel
Weight:	11.2kg (24.64lb)	Servos:	8 Servos

Heavy Duty Hardware Included!



A-BH093 Black Horse Edge 540V3 85cc ARTF..... £TBA

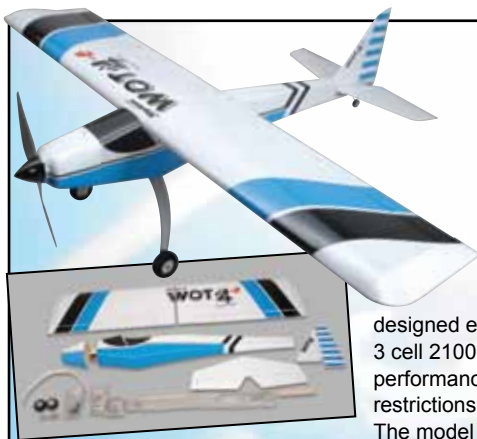

Ripmax WOT 4-E Mk2 ARTF

The demand has been growing for a tough yet superbly performing sport aerobatic model - what could fulfil this role better than a scaled down and purpose

designed electric version of the famed WOT 4? Developed around popular 3 cell 2100~2500mAh Li-Po battery packs, the WOT 4-E has an amazing performance and is ideal for small field use - or where there are noise restrictions - yet is large enough to hold its own at the busiest flying sites.

The model is strong and light with the additional benefit of an easy access battery mount with magnetically secured hatch cover - no need to take the wings off with this model!

Wingspan:	1200mm (47.0")
Length:	1050mm (41.0")
Motor:	KMS 2820/05 Recommended
Radio:	4 Channel with 4 Servos

A-CF003 Wot 4-E Mk2 ARTF..... £94.99

Stunning!

A Chris Foss Design

Ripmax WOT 4 FOAM-E Mk2 ARTF

This is not just any foam model! It's a very clever WOT 4 that can be flight ready in under 30 minutes! The beautiful EPO mouldings hide an innovative internal structure that adds strength where needed and locks all the components together.

The impressive specification includes a carbon main spar, carbon fuselage spine, shock resistant engine mount, simple battery access and battery retaining moulding, with further carbon reinforcement for the tailplane and ailerons.

The four servos, brushless motor and 30A ESC are all pre-installed. Just add a receiver and a 3 cell 2100~2500mAh battery of your choice then let the fun begin!

Receiver Ready!

A-CF020 WOT 4 Foam-E Mk2 ARTF..... £132.99

Wingspan:	1205mm (47.4")
Length:	1050mm (41.0")
Motor:	3536 820kV - Included
Radio:	4 Channel
Servos:	4 Included

A Chris Foss Design

Ripmax WOT 4 XL Mk2 ARTF

Is there anything better than the legendary WOT 4 - well there is now with the release of the new WOT 4 XL!

Boasting a 68" wingspan and with a huge 6.7 sq ft wing area combined with the light all up weight of around 8 ½ lbs (3.85Kg) means that the WOT 4 XL is even smoother and easier to fly, yet is still fully aerobatic, even at remarkably low airspeeds. This light wing loading also makes for an incredibly low stalling speed and simplifies landings, with a .90~1.20 two or four stroke engine being enough for a sparkling performance and extended verticals with engines at the top end of the range. Soon to be available as an option is a simple aerotow system, which can be retro fitted at any time, taking only minutes to install, and which is suitable for gliders of up to around 4m span and 7.0Kg weight.

Wingspan:	1730mm (68.0")
Length:	1535mm (60.4")
Engine:	.90~1.20 2 or 4 Stroke
Radio:	4 Channel with 5 Servos



A-CF004 Wot 4 XL Mk2 ARTF..... £194.99

A Chris Foss Design

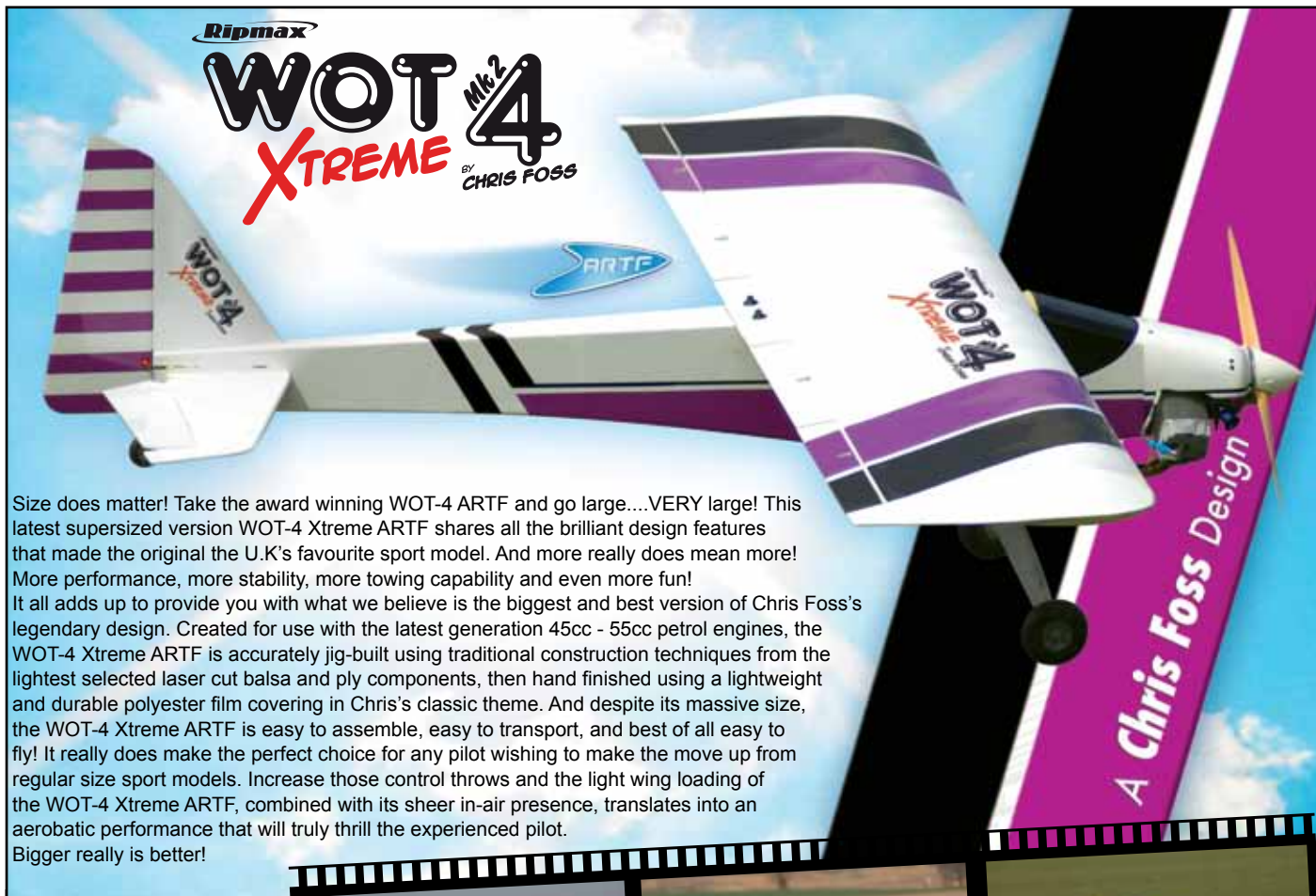

Ripmax
WOT-4 ^{Mk2}
Xtreme by CHRIS FOSS

Size does matter! Take the award winning WOT-4 ARTF and go large....VERY large! This latest supersized version WOT-4 Xtreme ARTF shares all the brilliant design features that made the original the U.K.'s favourite sport model. And more really does mean more! More performance, more stability, more towing capability and even more fun! It all adds up to provide you with what we believe is the biggest and best version of Chris Foss's legendary design. Created for use with the latest generation 45cc - 55cc petrol engines, the WOT-4 Xtreme ARTF is accurately jig-built using traditional construction techniques from the lightest selected laser cut balsa and ply components, then hand finished using a lightweight and durable polyester film covering in Chris's classic theme. And despite its massive size, the WOT-4 Xtreme ARTF is easy to assemble, easy to transport, and best of all easy to fly! It really does make the perfect choice for any pilot wishing to make the move up from regular size sport models. Increase those control throws and the light wing loading of the WOT-4 Xtreme ARTF, combined with its sheer in-air presence, translates into an aerobatic performance that will truly thrill the experienced pilot. Bigger really is better!



Large, Effective Flaps as Standard!

Perfect for 45 ~ 55cc Petrol Power!

Designer
 Chris Foss obviously delighted with the performance of the first WOT 4 Xtreme prototype

Wingspan:	2130mm (83.9")
Length:	1820mm (71.7")
Engine:	45 ~ 55cc Petrol
Radio:	5 ~ 6 Channel with 8 Servos

A-CF005 WOT 4 Xtreme ARTF.....£TBA

J-35 DRAKEN EP EDF ARTF

- Easy to Fly - Despite the Scale Outline
- 4300kV Brushless Motor Included
- Fully Aerobatic Performance
- Over 1:1 Thrust Ratio!

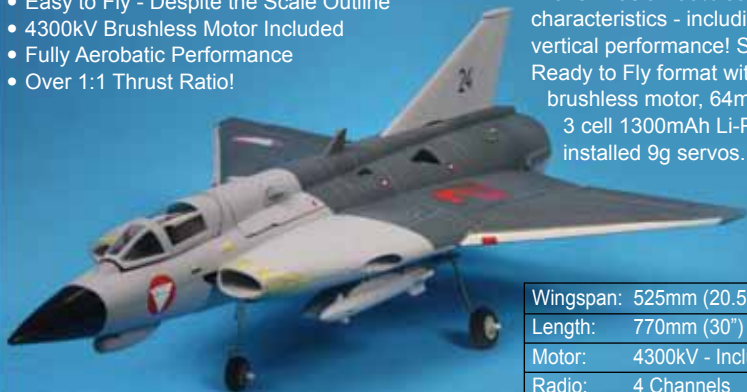

Wingspan:	525mm (20.5")
Length:	770mm (30")
Motor:	4300kV - Included
Radio:	4 Channels
Servos:	3 x 9g - Included

A-ED030**E-Do J-35 Draken EP ARTF £102.99**

The Saab J35 Draken is a classic Swedish jet and the subject of E-Do's new release. Never modelled before, the Draken has a 100% scale appearance and outstanding flight characteristics - including a 1:1 thrust ratio for unlimited vertical performance! Supplied in Almost Ready to Fly format with powerful 4300kV brushless motor, 64mm fan, 30 Amp ESC, 3 cell 1300mAh Li-Po and 3 factory installed 9g servos.

E-DOMODEL**Over 1:1
Thrust
Ratio!****F-86 EDF ARTF**

Wingspan:	700mm (27.5")
Length:	700mm (27.5")
Motor:	4300kV - Included
Radio:	4 Channels
Servos:	3 x 9g - Included

If you're looking for your first EDF model, the brand new F-86 Sabre takes some beating! Moulded from durable pre-painted EPO foam, it assembles quickly and comes complete with high performance brushless motor, 64mm fan, 30A ESC and three factory fitted 9g servos.

Simply add your choice of Tx, Rx and inexpensive 3S 1600mAh 20C Li-Po and you're ready to tear up the skies!

- Easy to Fly - Ideal First EDF
- 4300kV Brushless Motor
- Skyblazers Colour Scheme
- ESC and Servos Included

A-FR-1301C Freewing F-86 EDF ARTF £117.99**MIG 15 EDF ARTF****Ideal First
EDF!**

The perfect dog-fighting partner to its cold war adversary, the F-86 Sabre, the new Mig 15 features the same quick assembly and 64mm fan, factory fitted servos, powerful brushless motor and ESC. Tough factory-painted EPO construction.

- Easy to Fly - Ideal First EDF
- 4300kV Brushless Motor
- Factory Painted Colour Scheme
- ESC and Servos Included

A-FR-1601B Freewing Mig 15 EDF ARTF £117.99

Wingspan:	700mm (27.5")
Length:	700mm (27.5")
Motor:	4300kV - Included
Radio:	4 Channels
Servos:	3 x 9g - Included

FREEWING
Fully
Functioning
Canards!



Freewing have done it again! An astounding 90mm EDF almost ready to fly airframe with all servos, motor and ESC pre-installed. Just add your own receiver and Li-Po battery to complete. This model will not disappoint. The flight performance is stable at all speeds and the large wing area gives this big jet a very respectable glide too.

- Super Detailed Cockpit
- Midnight Flyers LED Light Set
- Scale Appearance
- 360 Degree Thrust Vectoring Nozzle
- Fully Functioning Canards
- 6-Blade, 90mm EDF Unit



**360°
Thrust
Vectoring!**

Wingspan:	960mm (37.8")
Length:	1400mm (55.1")
Motor:	1750kV - Included
Radio:	7 Channels
Servos:	11 x 9g - Included

A-FR-1501B Freewing Eurofighter EDF VT ARTF£409.99

HIROBO

It's difficult to improve upon perfection, but with the brilliant new SRB Quark SG helicopter, Hirobo have achieved the seemingly impossible!

This exciting new machine retains many of the features that made the original Quark one of the most respected and desirable mini electric helicopters available. Now adding further functionality in the form of collective pitch control, to create the ultimate RTF mini helicopter with true 3D flight performance.

If you insist on the very best, then this is it. Simple!

**3D Flight
Performance!**



Length:	361mm (14.2")
Rotor Span:	373mm (14.68")
Radio:	5 Channels
Weight:	200g



A-H0302-923 Hirobo SRB SG Quark 35MHz Mode 2.....£765.99

A-H0302-922 Hirobo SRB SG Quark 35MHz Mode 1.....£765.99

REVOLVER ARF

It's true: bigger is better! The bold, sleek looks and pilot-friendly handling of the mid-size Revolver is now available in .60 size Almost Ready to Fly format. It's more impressive in the air, easier to track in the sky and less affected by wind. And that's not all... it's a great choice for everything from simple sport flying to air show aerobatics - and capable of bigger, better performance with either glow or electric power! Its impressive size and traditional trim scheme are easy to track and see in most flight conditions. The fibreglass cowl, wheel spats and landing gear are factory painted to match the trim scheme. A built-up balsa/ply fuselage and a low parts count speed up final assembly time. The balsa-sheeted, foam-core, two-piece wing allows each wing panel to slide onto a joiner tube for transportation and storage ease. The Revolver performs equally well with glow or electric power and either power option installs with ease.

A-GPMA1019 Great Planes Revolver .61-.91 ARF..... £306.99



GREAT PLANES

Wingspan:	1780mm (70")
Length:	1460mm (58.5")
Engine:	.61-.75 cu.in. 2-Stroke
	.81-.91 cu.in. 4-Stroke
Radio:	4 Channel
Servos:	5 Servos Required



Wingspan:	1220mm (48")
Length:	1485mm (58.5")
Engine:	.61 2-Stroke, .70-.91 4-Stroke
	or brushless electric
Radio:	4-5 Channel
Servos:	6-8 Servos Required

GREAT PLANES

REACTOR BIPE GP/EP ARF

Reactors have established a reputation for classic lines and a wide flight envelope - and the Reactor Biplane .61 GP/EP ARF continues the tradition! It's based on the Reactor Bipe EP, but larger in size and with the capability for smooth sport manoeuvres and 3D aerobatics with your choice of outrunner brushless motor or glow engine. Lots of fibreglass parts add quality touches and pre-hinged ailerons speed final assembly.

The servo mount cutouts in the fuselage are sized for mini servos, but templates are included for enlarging them to accommodate standard size servos too. The large, airfoiled tail surfaces allow for smooth sport flying all the way up to incredible aerobatics, before slowing down for soft 3-point landings. Quality construction is evident in the fibreglass cowl, wheel spats and upper wing mounting pylon, which is glued in place to speed wing installation.

A-GPMA1023 Great Planes Reactor Bipe GP/EP ARF£331.99

ZLIN AKROBAT ARTF

Wingspan:	1470mm (58")
Length:	1320mm (52")
Engine:	.46-.55 cu.in. 2-Stroke or
	.52-.70 cu.in. 4-Stroke
Radio:	4-5 Channel
Servos:	4-5 Servos Required

GREAT PLANES

A-GMPA1024 Great Planes Zlin Akrobat ARTF..... £256.99



Based on the Zlin Z526A that has been popular since the 60s and 70s, this Great Planes model is a distinctive departure from the many CAPs, Extras and Edges currently found at the flying field.

The sheeted foam core wing can be built in one or two pieces, and the airfoiled tail surfaces are strong and lightweight. The Akrobat features a high-vis, scale MonoKote trim scheme, with decals included for German registration or U.S. 'N' numbers. The canopy doubles as an easy-access hatch for the battery compartment; magnets and a latch provide extra security.

An engine mount is included for installing a 4-stroke (shown here) or 2-stroke glow engine for added realism and exceptional performance. With its low parts count and extensive pre-assembly, the Zlin can be flight-ready in just a few hours.



FLYLITE EP ARTF

Great Planes' original concept for the FlyLite was to develop a slow-flying indoor trainer for beginners or pilots with little R/C experience. This goal was achieved... but then they found out how much fun it was to fly the FlyLite outdoors too! In calm conditions, beginners have all the space they need to detect what the FlyLite is doing, process the information, then make the necessary control inputs. Experienced pilots will find ways to challenge themselves and experiment with this surprisingly agile model. Perfect for 4g servo, 8 Amp ESC and 1700kV brushless electric power.

Wingspan:	890mm (35")
Length:	750mm (29.5")
Motor:	1700kV Brushless
Radio:	3 Channel
Servos:	2 x 4g Servos Required

Fly it Indoors or Out!

GREAT PLANES

A-GPMA1107 Great Planes Flylite EP ARTF..... £64.99



TIGER MOTH EP ARTF

Revolutionary realism in a classic military trainer. This lightweight foam Tiger Moth has plenty of detail moulded into the foam and plastic parts contributing to a realistic cowl and cockpit - with factory-installed windscreens. Other sport-scale touches include instrument panels, pilot figures and peel-resistant, pre-applied markings. Most small foam models use taped hinges - but the Tiger Moth has live hinges on the elevator and rudder, plus ribbing moulded into the foam structure. No other indoor foam model can match this Tiger Moth's accuracy - authentic down to the de Havilland logo on the wheels!

Wingspan:	760mm (30")
Length:	620mm (24.5")
Motor:	250 Class Brushless
Radio:	3 Channel
Servos:	2 Micro Servos Required

Very Easy to Fly!

GREAT PLANES

A-GPMA1134 Great Planes Tiger Moth EP ARTF.....£81.99

VFO SPORT 3D EP ARTF

Buy the VFO and you can say goodbye to building, big investments and boring, traditional appearance! Once it's out of the box, it's only about an hour from being ready for its first flight. Take it to the field and other pilots will be fascinated by its looks and amazed by the way it performs. It takes off like a rocket, hovers like a heli and flies like plane - and does all three on low-cost Li-Po packs and components.

- Ideal for sport, 3D stunts and learning how to hover!
- Super-stable yet aerobatic!
- Made of lightweight, finished foam parts, for fast assembly!

Wingspan:	675mm (26.5")
Length:	750mm (29.5")
Motor:	300 Class Brushless
Radio:	6 Channel
with Elevon Mixing	
Servos:	4 Servos Required

GREAT PLANES

A-GPMA1135 Great Planes VFO Sport 3D EP ARTF£37.99

RIFLE EP ARTF



100+ mph Performance!

Composite Construction

Wingspan:	785 mm (31")
Length:	620 mm (24.5")
Motor:	3180kV Brushless Inrunner
Radio:	2 Channel
Servos:	2 Micro Servos Required

- 'White knuckle' speed, with predictable handling and tracking
- Lightweight, factory-finished composite construction
- Compact, fast and easy to assemble

The Rifle EP is fast in the air... and fast to assemble too! Its composite fuselage, wing and tail mean that assembly takes only 1-2 hours. Both the wing and the tailplane bolt into place and align automatically and the factory finished trim scheme ensures you stay oriented during flight. Live hinge control surfaces maximise control effectiveness while minimizing deflection drag. High-quality hardware and accessories - including a machined aluminium spinner - contribute to the model's sleek appearance and superior performance. Requires a 3180kV brushless inrunner motor, 25 Amp ESC and 3 cell 1500mAh Li-Po.

GREAT PLANES

A-GPMA1805 Great Planes Rifle EP ARTF£137.99

SEQUENCE EP ARTF

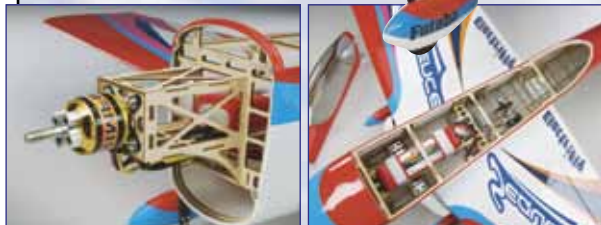

Wingspan:	1270mm (50")
Length:	1310mm (51.5")
Motor:	.32 Class 800KV Brushless
Radio:	4 Channel
Servos:	4 Micro Servos Required

A-GPMA1575 Great Planes Sequence EP ARTF..... £257.99



The Sequence is the first pattern ship in the ElectriFly line - and it's like no other pattern ship you've ever seen before. The airframe is exceptionally strong and ultra-light, to make the most efficient use of a brushless motor and Li-Po power. Its performance benefits from features drawn from today's most competitive custom ships. The Sequence's design features a brilliant 6 colour MonoKote trim scheme and bold graphics on the wing underside make orientation easy. Airfoiled tail surfaces improve both tracking and handling precision. With the ailerons factory-hinged for convenience, assembly takes just 4-6 hours from start to finish. The pre-built and factory covered balsa airframe, carbon fibre and painted fibreglass parts reduce work & weight at the same time.

SHOESTRING GP/EP ARTF



Wingspan:	1370 mm (54")
Length:	1195 mm (47")
Engine:	.40-.46 2-Stroke, .70-.81 4-Stroke or Brushless Electric
Radio:	4 Channel
Servos:	4-5 Servos Required

**One of the
Most Iconic
Midget
Racers!**

The full-size Shoestring's simplicity made it a favourite with builders...and its manoeuvrability and speed appealed to trophy-hunting pilots! Those same qualities make this ARTF model a must for anyone looking for easy assembly, exciting aerobatics, and a distinctive appearance. Mounting parts are included for installing glow engines or a brushless electric power system. Use whichever you prefer - no modifications are necessary. Remove the Shoestring's hatch and you'll find plenty of room inside the fuselage for easily installation of your on-board equipment. The foam core, balsa sheeted wing halves slide together onto a carbon fibre wing joiner. While the model fits into most vehicles fully assembled, it can easily be taken apart for compact carrying and storage. Like the full-size homebuilt, the Shoestring ARTF is designed to be economical both in cost and assembly time. Even the aileron hinges have been installed for you at the factory!

A-GPMA1328 Great Planes Shoestring GP/EP ARTF.....£239.99



EVADER EP ARTF

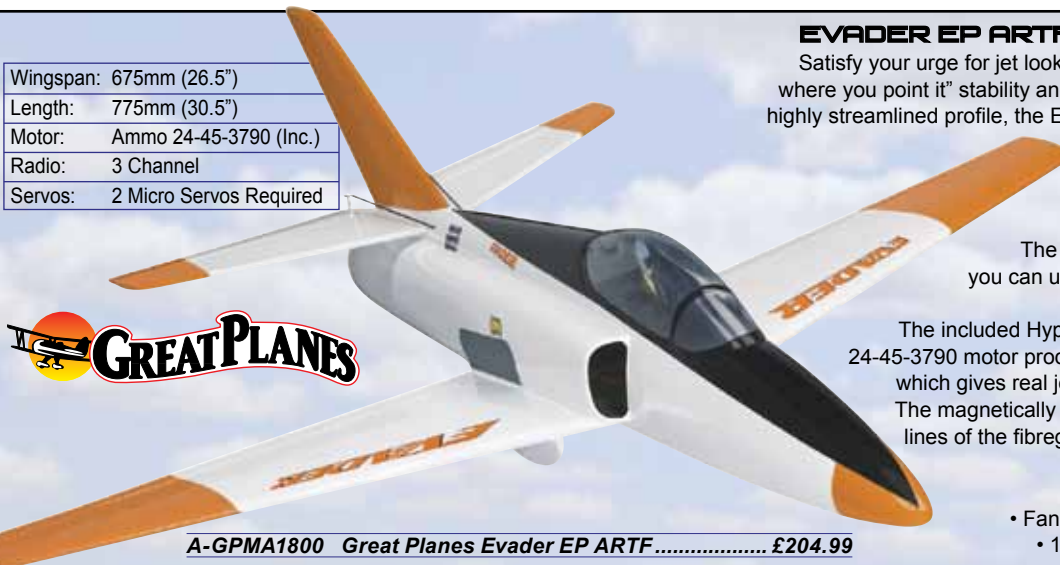

Wingspan:	675mm (26.5")
Length:	775mm (30.5")
Motor:	Ammo 24-45-3790 (Inc.)
Radio:	3 Channel
Servos:	2 Micro Servos Required

Satisfy your urge for jet looks and speed, while enjoying "goes where you point it" stability and thrilling sport aerobatics. With its highly streamlined profile, the Evader looks fast even when sitting still. The highly visible trim scheme makes following the model through high-speed manoeuvres straightforward.

The Evader can be hand launched - or you can use the included 15-foot bungee for even easier launching.

The included HyperFlow ducted fan unit with Ammo 24-45-3790 motor produces impressive thrust and speed which gives real jet excitement in a convenient size. The magnetically secured hatch maintains the sleek lines of the fibreglass fuselage while allowing quick battery installation and removal.

- Compact, lightweight design
- Fan unit and brushless motor included
- 100+ mph straight-and-level speed!

A-GPMA1800 Great Planes Evader EP ARTF..... £204.99

F-20 TIGERSHARK EP ARTF

Wingspan:	570mm (22.5")
Length:	940mm (37")
Motor:	Ammo 24-45-3790 (Inc.)
Radio:	3 Channel
Servos:	3 Micro Servos Required

 **GREAT PLANES**
A-GPMA1875 G.Planes F-20 Tigershark EP ARTF £184.99

With optimised air intake and exhaust areas helping to draw maximum speed from the F-20's included HyperFlow ducted fan system, this is a high performance aircraft capable of a show-stopping performance. Factory finished in this high visibility scheme and moulded from light and strong AeroCell foam.

Supplied complete with the state-of-the-art HyperFlow ducted fan unit and highly efficient Ammo 24-45-3790 brushless motor, the F-20 is primed for hyper speeds!

Decals and removable magnetic wingtip missiles are included and assembly of the F-20 Tigershark can be completed in as little as 4 to 6 hours. As with all ElectriFly models, a complete package of high-quality hardware is included.

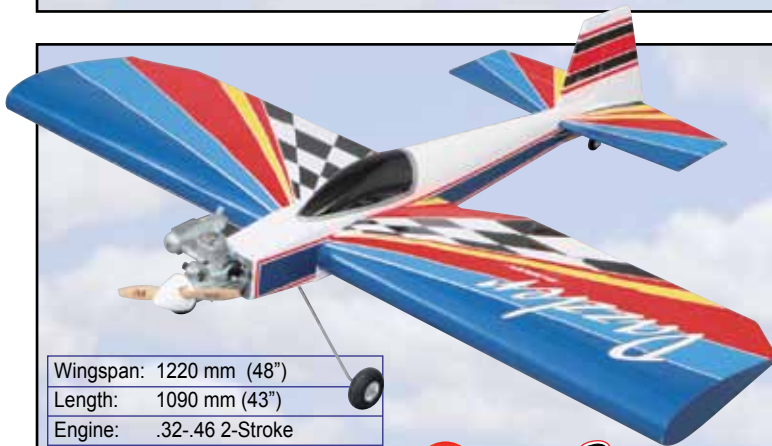

Wingspan:	1220 mm (48")
Length:	1090 mm (43")
Engine:	.32-.46 2-Stroke
Radio:	4-5 Channel
Servos:	5 Servos Required

 **GREAT PLANES**
DAZZLER 40 ARTF

Just 12-15 hours after opening the box, you can be ready to send your Dazzler ARTF through impressive aerobatics - twinkle rolls, knife edge, inverted flight and more. In fact, there's almost no manoeuvre that the Dazzler can't do - and a .40-size engine is all you need to power it through its paces. You'll be up in the sky with minimal time and effort... and once there, you won't want to come down! With factory-built and finished main structures, Great Planes branded hardware and detailed instructions, the Dazzler 40 ARTF is a fast and easy assembly project.

- Stunning manoeuvrability due to the oversized control surface and fully symmetrical wing section
- Pre-printed graphics in a bold and eye-catching scheme makes orientation easy

A-GPMA1038 Great Planes Dazzler 40 ARTF £139.99
YAK 54 3D EP ARTF

Great Planes designed the Yak-54 3D ARTF specifically for superior 3D performance – and the model spent a year in development. The result is a model with a truly outstanding 3D performance.

The Yak 54 assembles quickly from the factory built and covered laser-cut balsa and ply structures.

Oversized ailerons provide impressive roll rates and superior control at all flying speeds. With maximum throws it's 3D wild – ideal for parks and other small sites. Like the ailerons, the tail control surfaces are also oversized. They provide the model with impressive pitch and yaw authority – giving the experienced pilot the right tools for Walls, Parachutes, Blenders and more. Your choice of power system is easy to install, with motor mounts for both inrunner and outrunner motor types included.

Wingspan:	1040 mm (41")
Length:	960mm (38")
Motor:	Brushless In or Outrunner
Radio:	4 Channel
Servos:	4 Micro Servos Required

A-GPMA1542 Great Planes YAK 54 3D EP ARTF £134.99

 **GREAT PLANES**

TURBO CIRRUS SR-22 EP ARTF

Its manufacturer describes the full-size Cirrus SR22 Turbo as "an elite lifestyle". This officially licensed model reflects that superior workmanship. Due to its low weight, the Cirrus SR22 Turbo performs well with small, low-cost brushless motors. There is no cowl - and therefore no cowl lines to interrupt the clean, flowing lines of the fibreglass fuselage. The cockpit doubles as a removable hatch for easy access to the on-board battery and electronics. There's sufficient room inside the fuselage for the largest hands to work comfortably.

No plain wire landing gear here - the Cirrus SR22 Turbo deserves, and gets, high-quality aluminium gear with fibreglass wheel spats, plus a steerable nose wheel and smooth nose gear fairing.

A two-piece wing simplifies model transportation and storage. Factory hinged ailerons reduce assembly time even further.

A-GPMA1166 G.Planes Turbo Cirrus SR-22 EP ARTF£184.99



**Perfect for
Economical
Brushless
Components!**

Wingspan:	1285mm (50.5")
Length:	915mm (36")
Motor:	.10 Class Brushless
Radio:	4 Channel
Servos:	4 Micro Servos Required

GREAT PLANES

EAGLE 580 MATT CHAPMAN ARTF

Wingspan:	1350mm (53")
Length:	1460mm (57.5")
Engine:	.46-.61 2-Stroke, .52-.81 4-Stroke or .80 Class Brushless
Radio:	4 Channel
Servos:	4-5 Servos Required

**Fly it Electric
or I.C.!**

GREAT PLANES

Officially licensed and available only from Great Planes, the Eagle 580 .46 sport-scale ARTF brings the excitement of a Matt Chapman air show to your favourite flying site...with you at the controls. Painted fibreglass parts and die-cut decals recreate the signature look of Matt Chapman's full-size Eagle 580. The large Embry-Riddle logo underneath the wing is part of the expertly factory-applied MonoKote film covering. The main assemblies arrive built and covered, control surfaces (except rudder) are pre-hinged - and the cockpit comes complete with pre-installed pilot figure! The foam-core, balsa-sheeted wing and tailplane halves slide together onto carbon-fibre joiner tubes, aligning automatically. Instructions and mounting parts are included for installing a 2-stroke or 4-stroke glow engine or a brushless electric power system.

A-GPMA1281 G.Planes Eagle 580 M.Chap. 40/46£279.99

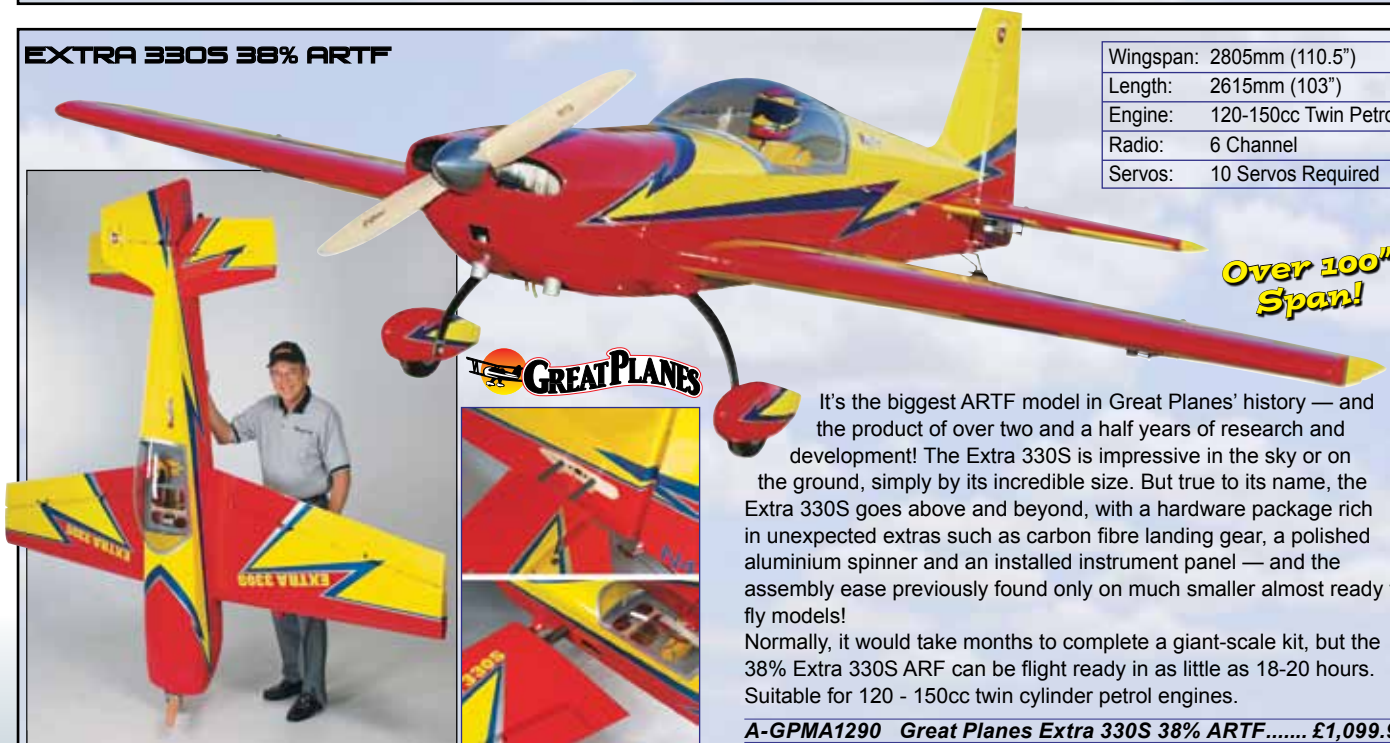
EXTRA 330S 38% ARTF

Wingspan:	2805mm (110.5")
Length:	2615mm (103")
Engine:	120-150cc Twin Petrol
Radio:	6 Channel
Servos:	10 Servos Required

**Over 100"
Span!**

It's the biggest ARTF model in Great Planes' history - and the product of over two and a half years of research and development! The Extra 330S is impressive in the sky or on the ground, simply by its incredible size. But true to its name, the Extra 330S goes above and beyond, with a hardware package rich in unexpected extras such as carbon fibre landing gear, a polished aluminium spinner and an installed instrument panel - and the assembly ease previously found only on much smaller almost ready to fly models! Normally, it would take months to complete a giant-scale kit, but the 38% Extra 330S ARF can be flight ready in as little as 18-20 hours. Suitable for 120 - 150cc twin cylinder petrol engines.

A-GPMA1290 Great Planes Extra 330S 38% ARTF £1,099.99

REALFLIGHT®

R/C FLIGHT SIMULATOR

The most realistic recreation of R/C flight ever!™

G5.5

Now with even more
**multiplayer
COMBAT
EVENTS**





The easy to use InterLink Elite is the most versatile flight sim controller you've ever seen. It's designed after Futaba's popular 6EX – complete with digital trims!

REALFLIGHT G5.5 SIMULATOR

In just over a decade, constant refinements have made RealFlight the world's most advanced and popular flight simulator as well as the most effective R/C flight training tool available. Now, you can experience its famous "at-field" accuracy in DeadRinger™ and Hardcore Combat — two new multiplayer combat events that push the envelopes of sim science and pilot skill farther out than ever before! In Hardcore Combat, sustaining high-g manoeuvres will cause progressively fading vision at best, and unconsciousness and a crash at worst. Being the first pilot to fly through the floating rings is difficult, but doing it while other pilots try to shoot you down...? Almost impossible...that's DeadRinger!

The multi-patented, easy to use InterLink Elite is also the most versatile flight sim controller you've ever seen. It's designed after Futaba's popular 6EX -complete with digital trims! Prefer to use your own R/C transmitter? The interface you need is already built-in!

- Over 80 Models to Fly
- More than 30 Flying Sites
- Even More Online Combat Options!

**Quite Simply, the Best
Model Flying Simulator
Available!**

Recommended System Requirements

- | | |
|---|--|
| <ul style="list-style-type: none"> • Windows Vista / Windows XP / Windows 7 • Dual Core 2.4GHz CPU • 2GB RAM • 4.5GB Hard Drive Space | <ul style="list-style-type: none"> • DVD Drive • USB Port • 3D Accelerated Video Card 512MB |
|---|--|

A-GPMZ4455 RealFlight G5.5 Simulator w/TX M2..... £169.99

A-GPMZ4458 RealFlight G5.5 Upgrade G3,3.5,4,4.5..... £69.99



YAK 54 ARTF**Everything
Included!****Mode 1 or 2
Switchable
Transmitter!**

For those that take their indoor flying seriously! The fabulous Nine Eagles YAK 54 is a full-on aerobatic model that can be flown indoors or out. With an average flying weight of around 35g, outside flying needs to be in calm conditions. This model is intended for experienced aerobatic flyers only. The controls are powerful, although two levels of response can be selected within the included transmitter.

The fuselage is a super-lightweight EPS shell and the wings/tail, solid injection moulded EPS. That structure has then been carefully painted in a stunning scheme (plus decals) that adds almost no additional weight. Nothing else needed required to get flying. Even the 4 AA dry cells for the transmitter are included. What's more, the box it comes in can double as a transport case!

Wingspan:	400mm (15.75")
Length:	355mm (14")
Motor:	Geared 8mm - Included
Radio:	4 Channels - Included
Servos:	3 Included (2 On-Board)

**A-NE202001A Nine Eagles YAK 54 RTF£71.99****P-47D ARTF**

This stunning P-47D is a semi scale, WW2 fighter model that can be flown indoors or out. With an average flying weight of around 35g, outside flying needs to be in calm conditions. This model is intended for experienced flyers only although a little easier to fly than the YAK 54. The patented propeller system is efficient and is designed to pop off the hub if it impacts anything. This saves the propeller from damage, and more importantly, the gearbox output shaft! Just two seconds late and it's clipped back on again. A wire undercarriage is provided, but this can be removed in seconds depending on your preference.

Wingspan:	400mm (15.75")
Length:	360mm (14.25")
Motor:	Geared 8mm - Included
Radio:	4 Channels - Included
Servos:	3 Included (2 On-Board)

**Lightweight
EPS
Construction!****A-NE214001A Nine Eagles P-47D RTF£71.99**



Lightweight EPS Construction!

Everything Included!

Weights Around 35g!

SPITFIRE RTF

With its beautiful elliptical wing shape and highly detailed scheme, there can be no doubt that this little gem is every inch a "Spit". Perfect for a spot of indoor flying at the sports hall, or outside in calm conditions, this Spitfire has everything in the one box required to fly. Includes 2.4GHz radio system for glitch-free operation, and the same brilliant patented propeller system as the P-47D. Not recommended for the complete novice, this iconic fighter is certain to put a huge smile on any experienced pilot's face!

A-NE206008A Nine Eagles Spitfire RTF £71.99

Wingspan:	395mm (15.82")
Length:	365mm (14.37")
Motor:	Geared 8mm - Included
Radio:	4 Channels - Included
Servos:	3 Included (2 On-Board)



P-51D MUSTANG RTF

Lightweight EPS Construction!

Weights Around 35g!

Everything Included!



Wingspan:	402mm (15.75")
Length:	373mm (14.68")
Motor:	Geared 8mm - Included
Radio:	4 Channels - Included
Servos:	3 Included (2 On-Board)

Sure to turn heads at any indoor flying event, this delightful semi-scale P-51D Mustang combines remarkable levels of performance and Warbird agility at a price that won't break the bank. The stylish 2.4GHz transmitter provides fuss-free operation and features a built-in fast charger for the flight battery (supplied). It can even be switched between modes 1 and 2! The patented propeller system reduces the risk of damage on those less than perfect arrivals and, although it's not recommended for the novice, any pilot with low-wing aileron experience will find it difficult to resist! When you consider all the fun and sparkling performance on offer from this 'one-box warbird', why should you?

A-NE114008A Nine Eagles P-51D RTF £71.99

SKY EAGLE RTF

The perfect model to start out in radio control flying without breaking the bank! The Sky Eagle has been purpose designed for the novice. Stable and forgiving in the air, it still has performance to put a smile on your face. The moulded, crash resistant EPO foam construction can take an amazing level of abuse and still come back for more. Assembly takes just a few minutes and is an extremely simple procedure.

Absolutely everything that you need is included, including the 4 AA dry cell batteries for the transmitter. A balance charger with mains power adaptor is provided for the 2 cell 250mAh Li-Po battery and flight times of up to 15 minutes are possible from a single charge!



**Everything
Included -
Nothing Else
to Buy!**

Wingspan:	500mm (19.7")
Length:	396mm (15.6")
Motor:	N50 - Included
Radio:	3 Channels - Included
Servos:	2 On-Board - Included

**Lightweight
EPO
Construction!**

A-NE24210	Nine Eagles Sky Eagle RTF	£66.99
A-NE24210/EUR	Nine Eagles Sky Eagle RTF (Euro)	£66.99



**Perfect for
the Beginner!**

SKY RUNNER RTF

So simple to assemble from the beautifully moulded, crash resistant EPO foam mouldings, the Sky Runner also flies just as well as it looks! With no undercarriage, the Sky Runner can be simply hand launched and belly landed. Hands are kept clear of the spinning propeller due to the attractive pusher configuration. And of course, with the motor at the back, it is not easily damaged in the event of a crash.

Using the Nine Eagles' patented pop-off propeller system to ensure that no damage can be done if it strikes something.

Just like the Sky Eagle above, everything is included - the model, radio, 2 cell 250mAh Li-Po flight battery, charger and 4 AA dry cell batteries for the transmitter.

Wingspan:	703mm (27.67")
Length:	514mm (20.23")
Motor:	N20 - Included
Radio:	3 Channels - Included
Servos:	2 On-Board - Included

A-NE207001A	Nine Eagles Sky Runner RTF	£71.99
A-NE207001A/EUR	Nine Eagles Sky Runner RTF Euro	£71.99

SKY CLIMBER RTF

The Sky Climber is a good sized electric glider that is equally suitable for beginners or experienced pilots alike. At 2 metres span it has quite a presence in the air and can be easily seen from a fair distance.

The powerful brushless motor and ESC are factory installed, as are the 4 servos. All you need to do is install your receiver and flight battery and you're ready to go flying!

Made from tough EPO foam, the Sky Climber can be docile as a trainer and aerobatic when required. Having both ailerons and rudder, the roll and turn response is immediate yet predictable. The wing section provides the right combination of high lift and good penetration into the wind. With favourable weather conditions, soaring poses no problems and long flights are easily possible. Even without lift, its low wing loading means that flights in excess of 20 minutes are the norm. A perfect introduction to powered gliders.



**Everything
Included!**

Wingspan:	2080mm (81.9")
Length:	1210mm (47.64")
Motor:	2835/1050kV - Included
Radio:	4/5 Channels
Servos:	4 x 9g - Included

**Powerful
Brushless Motor!**

A-NE014002A	Nine Eagles Sky Climber ARTF	£109.99
-------------	------------------------------------	---------

Nine Eagles



**Mode 1
or
Mode 2**

SOLO PRO RTF

Solo Pro is a small, lightweight yet robust helicopter with great performance. The perfect follow-on from a co-axial helicopter! The cleverly designed transmitter features the latest 2.4 GHz technology, a built-in charger for the flight battery and is easily changed between modes 1 and 2. A full compliment of spare parts is also available for those inevitable mishaps.

- Batteries Included
- Ideal for indoor use
- 2 x Factory Installed Servos
- Ready to Fly
- Available in 2 Colours
- Mode 1 or Mode 2

Rotor Diameter:	190mm
Length:	207mm
Motor:	x 2 - Included
Weight:	27g (0.95oz.)
Radio:	4 Channels - Included

**Everything
You Need to
Fly in One Box!**

A-NE24215	Nine Eagles Solo Pro V1 (Red) RTF	£71.99
A-NE24216	Nine Eagles Solo Pro V2 (Yellow) RTF	£71.99



Phase 3

**Factory Fitted
Servos, Motor
and ESC**

**High
Performance
Ducted Fan Unit**

2.4GHz version is supplied complete with high quality 2.4GHz transmitter and receiver!



PHASE 3 U2 ARTF

In the early 1950s, with Cold War tensions on the rise, the U.S. military required better strategic reconnaissance to help determine Soviet capabilities and intentions. It was thought an aircraft that could fly at 70,000 feet would be beyond the reach of Soviet fighters, missiles, and even radar. Phase 3 bring the iconic U2 spyplane to life in a high performance EDF that represents outstanding value.

Manufactured from lightweight foam, and available in either receiver-ready format, or complete with quality 2.4GHz transmitter and receiver.

Ready for your first exciting mission in no time!

- High Performance Ducted Fan, Brushless Motor & ESC Included
- 3 x Factory Installed Servos
- Li-Po Battery and Charger Included

A-PH022	Phase 3 U2	£132.99
----------------	-------------------------	----------------

A-PH022RTF	Phase 3 U2 2.4GHz.....	£169.99
-------------------	-------------------------------	----------------

Phase 3

Phoenix II

**Brushless
Motor and ESC
Included!**

- Brushless Motor and ESC Included
- 4 x Factory Installed Servos
- Li-Po Battery and Charger Included

2.4GHz version is supplied complete with high quality 2.4GHz transmitter and receiver!



PHASE 3 PHOENIX II GLIDER

This delightful model from Phase 3 offers sensational high-flying performance with a very down-to-earth price tag! Features a computer enhanced high aspect ratio wing which generates superb levels of lift. This excellent model is manufactured from very light but extremely durable EPO foam. The Phoenix is super-smooth in flight, with ample power on hand from the factory installed hi-performance brushless motor and matching ESC. Even the control servos have been factory fitted, so there really is very little to do before you can be soaring high! Supplied in radio ready format, perfect for your choice of transmitter and receiver, or complete with a quality 2.4GHz system.

A-PH021	Phase 3 Phoenix II.....	£132.99
A-PH021RTF	Phase 3 Phoenix II 2.4GHz.....	£169.99

ST MODEL

BLAZE
EPBLAZE
GLIDER

'the Blaze is a totally new kind of model that combines technical innovation with great looks & stunning performance

BLAZE EP

Wingspan:	1560mm (61.42")
Length:	1000mm (39.37")
Motor:	1130kV Outrunner (Inc.)
Radio:	4 Channels
Servos:	4 x 9g Included

The Blaze is set to re-define your concept of electric foam gliders. A bold statement? read on....

Never before has so much thought been lavished on an EP glider. The basic shell is crisply moulded in the established ST method of tough, EPO foam, but that is only part of the story. Hidden underneath that sleek exterior is a clever design that adds immense strength combined with design features that make assembly easy and accurate. Using a mix of carbon components, wooden formers and injection moulded plastic parts, you will be muttering 'how clever' as you screw it all together!

Available in two versions - as a glider with a built in towing release that is securely mounted to the plastic nose section for aerotowing from flat fields (with a servo to operate the release also installed) or as a high performance electric powered model supplied complete with 1130kV brushless outrunner and 30A ESC. Both come with servos factory fitted and require your choice of receiver to be installed - or go for the versions with 2.4GHz radio included!

Three internal carbon spars (one a super strong, square tube) are all bonded in internally and provide unbelievable strength to the Blaze's foam wing.

BLAZE GLIDER

Wingspan:	1560mm (61.42")
Length:	1000mm (39.37")
Radio:	3 Channels
Servos:	4 x 9g Included

A-STM090	ST Model Blaze EP ARTF.....£122.99
A-STM090A	ST Model Blaze EP ARTF 2.4G.....£174.99
A-STM100	ST Model Blaze Glider ARTF.....£91.99
A-STM100A	ST Model Blaze Glider ARTF 2.4G.....£142.99



**Probably the Best
Electric Trainer
Available!**

ST MODEL Discovery TRAINER

The ST Model Discovery is all about learning to fly... And we don't think you'll find a more easily assembled model! In fact, the time between opening the box and being ready to fly is measured in minutes not hours! In the air, there are few trainers that come close to matching its predictable flying, gentle stall and well-behaved ground handling. The computer designed structure has been optimised to give the best combination of performance and durability. With a traditional all-wood trainer, you can be grounded for weeks if a less than perfect landing damages it. Not so with the Discovery! As there's no glue required to assemble the model, a replacement part can be fitted in seconds!

Fantastic Flyer!

**No Glue
Required!**

Includes:
• Brushless Motor
• Brushless ESC
• 4 x 9g Servos

Wingspan:	1460mm (57.5")
Length:	1220mm (48")
Motor:	Brushless (Inc.)
Radio:	4 Channels
Servos:	4 x 9g Included

The Discovery is also available with a high quality ST Model 2.4GHz radio system, high capacity 1800mAh Li-Po flight battery and balance charger!

A-STM110 ST Model Discovery ARTF Trainer£122.99

A-STM110A ST Model Discovery RTF Trainer 2.4.....£183.99

FOCKE WULF 190A ARTF

ST MODEL

The FW-190A was a serious shock to the RAF when it came on the scene in 1942. ST have re-created a fabulous scale version of the FW-190A and lavished the level of detail on it that has not been seen on a foam model before. There is a fully scale retracting undercarriage with contoured doors and working, sprung oleo struts and even flaps. The control surface hinges are fully hidden and the horns/pushrods have been minimised so as not to spoil the scale appearance. The powerful brushless, outrunner motor drives a scale, 3-bladed propeller, spinner and integral fan. Just like the real one!!! Power control comes from the latest 36A ESC with integral BEC circuit. That BEC is more than enough for the five pre-installed, 9g servos. The stunning colour scheme and decals are the icing on the cake, giving this FW-190 the 'wow' factor that she richly deserves.

Includes:
• Brushless Motor
• Brushless ESC
• 5 x 9g Servos

**Scale
Retracts
Included!**

Wingspan:	1130mm (44.5")
Length:	995mm (39.2")
Motor:	Brushless (Inc.)
Radio:	5 Channels
Servos:	5 x 9g Included

A-STM120 ST Model FW-190A EP ARTF £139.99

P-40 WARHAWK GIANT SCALE ARTF**A-TOPA0705****P-40 Warhawk Giant Scale ARTF.....£714.99**

Made famous by Colonel Claire Chennault's 'Flying Tigers' squadron at the onset of World War II, the P-40 Warhawk had one of the most impressive kill-to-loss ratios of any Allied fighter plane. Equally impressive is Top Flite's replica of the P-40, which utilises Gold Edition engineering to capture this revered warbird in a great flying ARTF model!



Wingspan: 2185mm (86")

Length: 1830mm (72")

Engine: 43-50cc Petrol

Radio: 5 - 9 Channels

Servos: 9 Required

- Built-up balsa and ply airframe with fibreglass cowl, belly pan and landing gear pods.
- Exceptional scale flight characteristics using affordable and easy-to-maintain 43-55cc petrol engines.
- Many scale touches that you won't find on any other giant scale ARTF!

P-47 THUNDERBOLT 60 ARTF

Four-blade prop shown not included.



Wingspan: 1600mm (63")

Length: 1420mm (56")

Engine: .90 - 1.20 4-Stroke or .60 - .90 2-Stroke

Radio: 6 Channels

Servos: 8 Required

A-TOPA0955**P-47 Thunderbolt 60 ARTF £389.99**

This P-47 ARTF model earns the description 'exceptional' in its own right. The detail and quality will impress even the most discriminating scale modeller.

Top Flite went beyond its already high standards for construction quality and scale realism to create this model. It assembles in only 15-20 hours

and has the appearance of something you've built from a kit. The checkerboard pattern painted onto the fibreglass cowl follows every contour perfectly. Few die-hard kit builders would have the patience and skill to achieve such striking results.

Top Flite includes flat finish decals for three different nose art options - all historically accurate artwork from actual WWII P-47D Thunderbolt aircraft. Customise your model with your favourite!

- Assembles in as little as 15-20 hours
- Built-up and sheeted wood construction, covered in flat-finish film
- Durable, high-quality mechanical retracts
- Painted cowl, detailed cockpit and three nose art decal options

AT-6 TEXAN .60 ARTF

Wingspan: 1755mm (69")

Length: 1295mm (51")

Engine: .70 - .91 4-Stroke or .61 2-Stroke

Radio: 6 Channels

Servos: 8 Required

A-TOPA0965**AT-6 Texan .60 Size ARF w/Retracts..... £349.99**

Ready to try a scale warbird? From its authentic trim colour scheme to the scale cockpit interior, this Gold Edition ARTF model does the original proud. It's your turn to be a scale ace...and Top Flite makes it easy! Top Flite pays attention to scale realism long past the point that most other manufacturers consider 'good enough'. Gold Edition quality distinguishes this model from all other ARTFs. In addition to the factory-built and covered wood main

sections, Top Flite includes realistic wheel covers, replica radial engine, greenhouse canopy and many other fine scale parts.

- Built-up and sheeted wood construction, with fibreglass cowl and aluminium spinner
- Assembles in 18-25 hours
- Sturdy, high-quality mechanical retractable landing gear included



P-40 WARHAWK 60 ARTF

The single-engine Curtiss P-40 took its maiden flight in 1938, and its fierce reputation continues to this day. This exceptional

Top Flite ARTF model comes loaded with a level of scale detail which will impress even the most discriminating warbird modeller. Gold Edition ARTF warbirds are famous for their authentic appearance, and the Warhawk is no exception. A realistic, eye-catching cockpit is just one of the notable features - ready for you to fit your favourite pilot figure. The painted fibreglass cowl recreates the iconic 'shark's mouth' design used by the Flying Tigers. A painted aluminium spinner also comes standard. Top Flite includes flat-finish decals.

- Highly detailed cockpit
- Built-up and sheeted wood construction, covered in flat-finish MonoKote
- Painted fibreglass cowl, exhaust ports and landing gear pods
- Assembles in as little as 15-20 hours

Wingspan:	1640mm (64.5")
Length:	1395mm (55")
Engine:	.90 - 1.20 4-Stroke or .60 - .91 2-Stroke
Radio:	5 Channels
Servos:	7 - 8 Required

**Flat-Finish
MonoKote Film
Covering**

A-TOPA0970 P-40 Warhawk 60 ARTF..... £409.99



RTR Mini EP Deep Vee Racer

Offering the perfect blend of high performance at an incredibly low price, the new Joysway Offshore Lite Warrior is set to make a big splash! The all-moulded hull is supplied complete with a factory fitted water cooled motor, matching 30A ESC, steering servo, two channel pistol-grip transmitter with 9V battery, 9.6V Ni-MH battery and mains operated charger. Maximum fun, minimum money!

Length:	420mm (16.5")	ESC:	30A (Inc.)
Beam:	110mm (4.3")	Radio:	2 Channel (Inc.)
Motor:	480 Class (Inc.)	Weight:	455g

B-JS-8201 Offshore Lite Warrior RTR£71.99



OFFSHORE LITE SEA RIDER RTR

Sharing a similar technical specification as the brilliant Offshore Lite Warrior, the Offshore Lite Sea Rider makes a perfect choice for catamaran fans. Features a fully moulded hull design that is both super-stylish and very durable, supplied complete with factory fitted water-cooled motor, matching 30A ESC, steering servo and an ergonomically friendly two channel transmitter. Joysway even supply a rechargeable 9.6V battery and mains operated charger, so there really is nothing else to buy before the hi-performance action can commence!

Length:	420mm (16.5")	ESC:	30A (Inc.)
Beam:	120mm (4.7")	Radio:	2 Channel (Inc.)
Motor:	480 Class (Inc.)	Weight:	455g

B-JS-8202 OffShore Lite Sea Rider RTR £71.99

RC hobby world
Joysway

DISCOVERY YACHT RTR - 600MM GRP

There can be very few yachts that can match the appeal, high specification and sheer value on offer from the Joysway Discovery. From the factory painted fibreglass hull, supplied with a one-piece keel - mirror finished in chrome, to the performance inspired jib and mainsail manufactured from top quality rip-stop nylon. The factory installed 2.4GHz radio control system features two powerful 5Kg servos for even more hi-performance fun! This magical model yacht makes a perfect choice as a first model, but with the sophisticated hull design and built-in rig 'tuning' to make it excel in a wide range of wind conditions, it makes a great choice for a group of experienced skippers looking for a suitable, inexpensive one-design club racer.

Length: 610mm (24")	Overall Height: 1170mm (46")
Beam: 175mm (7")	Total Sail Area: 17.2dm ² (266.6sq in)
Mast Height: 860mm (34")	Total Weight: 1.35Kg (3lbs)

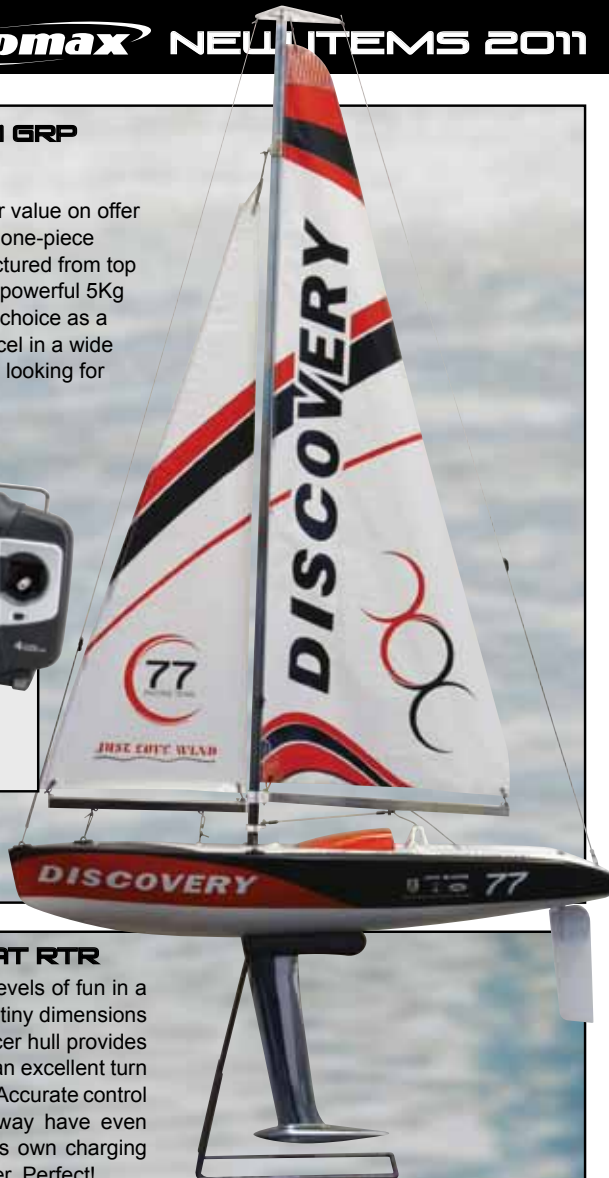

B-JS-9901G	Discovery Yacht RTR - 600mm GRP (Green)	TBA
B-JS-9901R	Discovery Yacht RTR - 600mm GRP (Red)	TBA
B-JS-9901B	Discovery Yacht RTR - 600mm GRP (Blue)	TBA

JOYSWAY CARIBBEAN 1:46 SAILBOAT RTR

The diminutive 1:46 scale Caribbean yacht offers huge levels of fun in a compact and easy-to-transport package. Don't let those tiny dimensions fool you...this is no toy. The factory moulded cruiser/racer hull provides excellent handling in all but the roughest waters, with an excellent turn of speed courtesy of the pre-fitted rip-stop nylon sails. Accurate control is provided by two separate 9g servos, and Joysway have even provided a 3.7V rechargeable Li-Po battery with its own charging port built into the stylish and easy-to-use transmitter. Perfect!

Length: 260mm (10.2")	Overall Height: 435mm (17.1")
Beam: 90mm (3.5")	Total Sail Area: 2.47dm ² (38.3sq in)
Mast Height: 320mm (12.6")	Total Weight: 175g (6.17oz)

**Available in
3 Exciting
Colours**



RC hobby world
Joysway



B-JS-8801 Joysway Caribbean 1:46 Sailboat RTR £56.99



**MAGIC CAT RTR MICRO
EP SPEED BOAT**

**20km/h
Performance!**



Length:	220mm (8.7")	ESC:	5A (Inc.)
Beam:	72mm (2.8")	Radio:	2 Channel (Inc.)
Motor:	180 Class (Inc.)	Weight:	125g

Hot on the heels of the brilliant Magic Vee micro racer from Joysway is the exciting new Magic Cat! Despite its diminutive size, this mini marvel is capable of reaching an amazing 20km/h with its powerful water cooled 180 size motor! Supplied complete with quality two channel radio and 5A speed controller, the Magic Cat includes a mains operated AC Charger (for the supplied 7.2V Power Pack) and a 9V Dry Battery (for Transmitter). Nothing else required to complete!

B-JS-8102 Magic Cat RTR Micro EP Speed Boat..... £45.99

OFFSHORE WARRIOR RTR - 2.4GHZ

The Joysway Offshore warrior is perfect for your local pond, river or model boating area. Seriously fast, easy to control and best of all great fun... but don't be fooled into thinking they are toys, because they aren't! With an extremely durable fibreglass hull, water cooled brushless motor and ESC, installed steering servo and precision CNC machined anodised hardware these are serious competitors - They even come with a free boat stand for maintenance! All pre-assembled, including the 2.4GHz radio system, just add a suitable 3S Li-Po battery of your choice to get running. Available in different colours to suit your personal taste and allowing you to race your friends!

Length:	450mm (17.7")	ESC:	30A (Inc.)
Beam:	120mm (4.7")	Radio:	3 Channel (Inc.)
Motor:	3000kV Brushless (Inc.)	Weight:	550g



B-JS-9301BR/2-4G Offshore Warrior RTR - Black/2.4GHz £154.99

B-JS-9301RR/2-4G Offshore Warrior RTR - Red/2.4GHz £154.99

B-JS-9301YR/2-4G Offshore Warrior RTR - Yellow/2.4GHz... £154.99

Joysway RC hobby world



OFFSHORE SEA RIDER RTR - 2.4GHZ

The Joysway Offshore Sea Rider features a durable factory-finished fibreglass hull, water cooled brushless motor with matching ESC and top quality anodised aluminium hardware! The result? A high performance racer that not only looks stunning but has the handling and performance to match! The factory installed 2.4GHz radio system provides precision control with frequency clash-free operation! It even comes with a free boat stand for maintenance and display purposes! Just add a suitable 3S LiPo battery of your choice to get running. Available in a choice of exciting easy-to-track colours, perfect for racing your friends!

Length:	450mm (17.71")	ESC:	30A (Inc.)
Beam:	135mm (5.31")	Radio:	3 Channel (Inc.)
Motor:	3000kV Brushless (Inc.)	Weight:	600g

B-JS-9302BR/2-4G Offshore Sea Rider RTR - Black/2.4GHz £154.99

B-JS-9302RR/2-4G Offshore Sea Rider RTR - Red/2.4GHz £154.99

B-JS-9302YR/2-4G Offshore Sea Rider RTR - Yellow/2.4GHz £154.99

OFFSHORE SEA DRIFTER RTR - 2.4GHZ

With its cutting edge design and striking appearance the Joysway Sea Drifter turns heads before it hits the water! Once afloat it redefines the meaning of the word fast! Despite the performance on offer, its compact dimensions make it suitable for use on most average size boating ponds. Manufactured from top quality fibreglass, the durable Sea Drifter is supplied with a factory fitted water-cooled brushless motor and matching high performance ESC. Precision control is provided by the factory installed 2.4GHz radio system complete with powerful 9g steering servo. Simply add your choice of suitable 3S Li-Po battery and you're good to go! The only difficult decision is which exciting colour to choose!



B-JS-9303RR/2-4G Offshore Sea Drifter RTR-Red/2.4GHz£154.99

B-JS-9303YR/2-4G Offshore Sea Drifter RTR-Yellow/2.4GHz ...£154.99

RC hobby world
Joysway

RC hobby world
Joysway

X-BLAZE EP BRUSHLESS RTR 2.4GHZ**X-BLAZE SUPER BRUSHLESS RTR 2.4GHZ**

The sleek and purposeful lines of the new Joysway X-Blaze tell you instantly that this is a very special R/C power boat. Supplied completely factory built in durable fibreglass, with a choice of two brushless motor/ESC combinations and a factory installed 2.4GHz radio control system for total control. The standard X-Blaze EP is staggeringly fast (60+ km/h) and is perfect for use with 2 x 7.4V 3700mAh Li-Po packs (not included). The X-Blaze Super offers performance that approaches insane! Optimised for use with 2 x 11.1V 4000mAh Li-Po packs (not included) for a top speed of in excess of 85 km/h! this has to be the ultimate R/C thrill!

Length:	610mm (24")	Weight:	1.15 - 1.45kg
Beam:	185mm (7.3")	Radio:	2 Channel (Inc.)

X-BLAZE EP**X-BLAZE SUPER**

Motor:	B3656 Brushless	Motor:	B4563 Brushless
ESC:	50A (Inc.)	ESC:	90A (Inc.)
Propeller:	2 Blade Nylon	Propeller:	3 Blade Copper

B-JS-9201/2-4G X-Blaze EP Brushless RTR 2.4GHz £227.99

B-JS-9201H/2-4G X-Blaze Super Brushless RTR 2.4GHz.... £389.99

Both versions
supplied
complete with
factory installed
2.4GHz radio



**X-Blaze EP
60+km/h
Performance!**

**X-Blaze Super
85+km/h
Performance!**

RC hobby world
Joysway

SEA FIRE EP BRUSHLESS RTR 2.4GHZ**SEA FIRE SUPER BRUSHLESS RTR 2.4GHZ**

You want speed... you want performance. Sea Fire EP delivers both. Supplied completely factory built in durable fibreglass, with a choice of two brushless motor and ESC combinations with factory installed 2.4GHz radio control system. The Sea Fire EP is spectacularly fast (65+ km/h) and is perfect for use with 2 x 7.4V 3700mAh Li-Po packs (not included). The Sea Fire Super has a really blistering performance! Optimised for use with 2 x 11.1V 4000mAh Li-Po packs (not included) for a top speed of in excess of 85+km/h! Buckle up and hold on tight.

**Sea Fire EP
65+km/h
Performance!**

**SEA FIRE EP****SEA FIRE SUPER**

Motor:	B3656 Brushless	Motor:	B4563 Brushless
ESC:	50A (Inc.)	ESC:	90A (Inc.)
Propeller:	2 Blade Nylon	Propeller:	3 Blade Copper

Length:	580mm (22.8")	Weight:	1.15 - 1.55kg
Beam:	330mm (13")	Radio:	2 Channel (Inc.)

B-JS-9202/2-4G Sea Fire EP Brushless RTR 2.4GHz £229.99

B-JS-9202H/2-4G Sea Fire Super Brushless RTR 2.4GHz... £389.99



SURGE CRUSHER BRUSHLESS RTR 2.4GHZ **SURGE CRUSHER SUPER BRUSHLESS RTR 2.4GHZ**

Inspired by the fastest full-size offshore catamarans, this Surge Crusher is available in two high performance versions. Both feature top quality fibreglass hulls and factory installed 2.4GHz radio control systems. The Surge Crusher E.P offers amazing performance with 2 x 7.4V 3700mAh Li-Po packs (not included). The Surge Crusher Super is not recommended for those of a nervous disposition, with 2 x 11.1V 4000mAh Li-Po packs (not included) performance is best described as truly awesome! Yes... we really do mean speeds in excess of 85km/h!!

Surge Crusher
65+km/h
Performance!

Surge Crusher
Super 85+km/h
Performance!

SURGE CRUSHER BRUSHLESS

Motor:	B3656 Brushless
ESC:	50A (Inc.)
Propeller:	2 Blade Nylon

Length:	610mm (24")
Beam:	210mm (8.3")

SURGE CRUSHER SUPER BRUSHLESS

Motor:	B4563 Brushless
ESC:	90A (Inc.)
Propeller:	3 Blade Copper

Weight:	1.15 - 1.55kg
Radio:	2 Channel (Inc.)

B-JS-9203/2-4G	Surge Crusher Brushless RTR 2.4GHz... £229.99
B-JS-9203H/2-4G	Surge Crusher Super B. less RTR 2.4G... £389.99

JOYSWAY INVINCIBLE RAZOR HS RTR

The Invincible Razor from Joysway offers an outstanding combination of super-sleek good looks, high performance Deep-Vee hull design and incredible performance! Inside that glossy fibreglass hull lies an immensely powerful water-cooled brushless motor complete with matching ESC, CNC machined aluminium running gear and factory installed R/C. Optimised for use with 2 x 11.1V 4000mAh Li-Po battery packs (not included), this superb powerboat backs-up those stunning looks with handling and speed that will amaze you!

Over 70km/h
Performance!

Joysway
 RC hobby world

Length:	580mm (22.8")	Weight:	1.15 - 1.55kg
Beam:	330mm (13")	Radio:	2 Channel (Inc.)

B-JS-9501HR **Joysway Invincible Razor HS RTR... £326.99**

OFFSHORE SEA DRIFTER EP RTR - 2.4GHZ

Want to experience the ultimate thrill of driving an 80+ km/h model hydroplane? Then look no further! The Sea Drifter is manufactured from durable high gloss fibreglass, with a geared and watercooled brushless motor driving through a low friction 5mm flex drive. Includes a factory installed ESC, R/C equipment and top quality CNC machined aluminium hardware. Requires 2 x 7.4V 4000mAh Li-Po batteries (not included). The Sea Drifter offers levels of performance that used to be the domain of custom built specialist boats. Go on....you know you want to!

80+km/h
Performance!

B-JS-9206H/2-4G

Sea Drifter EP Brushless RTR 2.4GHz... £379.99

Joysway
 RC hobby world

RC hobby world Joysway

JOYSWAY SURGE CRUSHER 26CC RTR

It's all about the performance... from the powerful 26cc water-cooled petrol engine, to the precision aluminium running gear, the Surge Crusher has been created with maximum performance in mind! Supplied completely assembled and ready-to-run with factory installed 2.4GHz radio system and superb fibreglass hull, the Surge Crusher is a truly sensational power boat that will turn heads wherever it's run!

**60km/h
Performance!**

- Work Stand
- Water Cooling
- 26cc Petrol Engine
- 30 Minute Duration
- 500cc Petrol Tank
- 2 Blade Alloy Propeller
- 6mm Flex Shaft Drive Cable
- Alloy Turn Fins and Hardware

**26cc Petrol
Engine
Included!**

**2.4GHz
Radio
Included!**

Length:	1340mm (52.75")
Beam:	400mm (15.74")
Weight:	6.1kg (13.44lb)
Material:	Fibreglass

B-JS-9103N Joysway Surge Crusher 26cc RTR..... £TBA

JOYSWAY OFF-SHORE WARRIOR 26CC RTR

If you're ready to take your passion for off-shore power boats to the next level, you're ready for the awesome Off-Shore Warrior from Joysway. This sleek beauty is no ordinary powerboat. From the immense 1210mm race optimised hull, manufactured from super-tough fibreglass, to the massively powerful 26cc petrol engine, it's every inch a thoroughbred. Capable of eye-watering speeds in excess of 60km/h, the Off-Shore Warrior comes to you complete with a factory installed 2.4GHz radio system, powerful hi-torque servos, CNC machined aluminium running gear, and a super smooth 6mm flex-cable drive system. Twin alloy turn fins ensure pin-sharp handling and the large 500cc fuel tank provides extended run times of around 30 minutes, perfect for those endurance race events! This is not a boat for the faint hearted, but if you're looking for the ultimate in high performance action, the Off-Shore Warrior is unbeatable.

**60km/h
Performance!**

- Work Stand
- 500cc Petrol Tank
- Water Cooling
- 2 Blade Alloy Propeller
- 26cc Petrol Engine
- 6mm Flex Shaft Drive Cable
- 30 Minute Duration
- Alloy Turn Fins and Hardware

Length:	1210mm (47.63")
Beam:	310mm (12.2")
Weight:	5.3kg (11.68lb)
Material:	Fibreglass

B-JS-9101N Joysway Off-Shore Warrior 26cc RTR..... £TBA



Leopard Buggy



C-FG67005 Leopard 2 Buggy 2WD Comp Kit (Hydraulic Brakes)....£2,599.99

FG Modellsport's new Leopard 2 and 4 wheel drive competition buggies have been designed from the ground up to be winners! Precision milled aluminium and carbon fibre parts abound on platforms that have been CAD designed and extensively track tested to reach the peak of mechanical performance. Supplied in kit form with included Zenoah 26cc petrol engines as standard, no corners have been cut in the creation of these fantastic cars!

Features:

- Precision Milled Angled Aluminium Chassis
- Carbon Fibre Chassis Stiffeners
- Zenoah 26cc Petrol Engine
- Tuned Pipe
- 700ml Flip Top Fuel Tank
- Large Volume Adjustable Coil Over Oil Shocks
- Hydraulic Disc Brakes, Front and Back
- Geared Differential (x 2 for 4WD)
- Ball Drive System
- FG Competition Wheels and Tyres
- Polycarbonate Body Shell and Wing
- Fully Ballraced

Required for operation (Not included):

3 Channel Radio with 2 x Heavy Duty Servos (20~30Kg) for steering, 1 servo for throttle/rear brake, 1 servo for front brake (both minimum 15Kg), suitable battery pack and charger



C-FG67000 Leopard 4 Buggy 4WD Comp Kit (Hydraulic Brakes)....£2,999.99



XT2^e

X-TERMINATOR 2^e BRUSHLESS

Super strong aluminium braces (5mm thick) and shock towers (4mm thick)

For years, XTM Racing's XT2 has been at the front of the 1/8 Nitro RTR market with its incredible value, amazing features, high level performance, and a reliability that lets you sleep at night. Based on this success, XTM Racing has now introduced the XT2e which takes the 1/8 nitro buggy platform and transforms it into an electric powered missile!

120 Amp electronic speed control with large cooling fan designed specifically for 1/8 application

The XT2e is filled with numerous features that any entry level driver or professional can appreciate. With the included XTM X-120 Electronic Speed Control and X-2370 Brushless Motor, the XT2e can be launched to speeds of over 45MPH while running at optimised temperatures thanks to a massive cooling fan on the speed control and large heat-sink on the motor! Customised settings can also be applied to the electronic speed control thanks to the included program card, where setups can be adjusted from mild to wild! It's a simple matter of plugging in your favourite battery pack(s) and driving! The XT2e is a quiet, trouble-free and reliable platform that allows everyone to spend more time racing instead of working on, and tuning, an equivalent nitro powered vehicle. Get the XT2e and start driving today!

Included electronic speed control program card allows you to customise set up to suit your driving style

Specifications:
 Length: 483mm
 Height: 154mm
 Width: 305mm
 Wheelbase: 324 ~ 330mm
 Weight: 3.63kg

C-XTM-XT2E XT2e Brushless Buggy 1:8 4WD RTR..... £339.99



XTM Racing introduces a new class of enjoyment to the R/C community with the Rail! A 1/8 scale brushless-powered RTR off road buggy with the styling and performance of a full-size sand rail! However, XTM Racing's Rail isn't restricted to sand use. The installed all-terrain tyres allow you to take the Rail on all types of surfaces from dirt to street, and places in between!

Launching the Rail to ballistic speeds is an industrial grade brushless speed control, with massive built-in fan unit, and powerful brushless motor with installed heat-sink and dual fans to keep everything cool - XTM Racing knows that heat and electronics simply don't mix! This combination of power and cooling has eliminated the possibility of thermal shutdowns and ensures owners can enjoy the Rail each and every run, whether using a simple 6-cell Ni-MH or more elaborate 4S Li-Po battery pack.

Drivers can feel confident that all internal equipment is well protected with the custom aluminium roll cage and side frames which are harnessed together to provide a rigid and stable chassis. Supporting the Rail are threaded aluminium coil-over oil-filled shocks at each corner which soak up the terrain with ease for a smooth ride. With adjustable steel gear differentials, adjustable suspension geometry, and optional sand paddle tyres, the Rail is sure to deliver performance and stability anywhere you take it! If you think the Rail looks good standing still, just drive one and be the centre of attention!

Custom aluminium roll cage protects the internals of the Rail and is secured to aluminium side frames and chassis to provide an extremely rigid platform.

Threaded aluminium coil-over oil-filled shocks support the Rail at all four corners. Completely adjustable with optional oils and springs.

A massive fan on the speed control, plus dual fans mounted to the large heat-sink on the brushless motor keeps electronics cool and prevents overheating.



C-XTM-RAILBL Rail Brushless Buggy 1:8 4WD RTR.....£369.99

Specifications:
 Length: 432mm
 Height: 156mm
 Wheelbase: 292 ~ 299mm
 Width: 330mm/333mm (Fr/Rr)
 Weight: 1.56kg

Aggressive pattern high-grip tyres offer incredible traction

Efficient brushless electronic speed control includes transparent cooling fan to prevent over heating

Powerful 3600kV brushless motor provides awesome speed and efficiency while machined grooves dissipate heat

The X-Cellerator Brushless is a 1/10 stadium truck that really means business! With its race inspired transmission, tyres and shocks, the X-Cellerator Brushless is great for any basher or racer. Speeds of 50+ mph can be obtained using the stock electronics without having to spend additional money on expensive motors or speed controls! The powerful 3600kV brushless motor has plenty of speed and torque and the electronic speed control can handle anywhere from 7.2 up to 12V for insane power with a built-in fan unit. Featuring adjustable aluminium coil over oil-filled shocks, ball differential assembly, aggressive pattern tyres, slipper clutch, adjustable turnbuckles and a completely countersunk chassis! These features put this truck at the top of its class!

Completely adjustable slipper clutch and ball differential assemblies

C-XTM-XCBL X-Cellerator Brushless 1:10 2WD RTR TBA

RAIDER

**FACTORY
ASSEMBLED**

ARTR
ALMOST READY TO RUN

90% COMPLETE
REQUIRES RADIO-GEAR
AND BATTERY



'ARRMA'
WE ARE RADIO CONTROL

From the first moment you see the all-new Arrma RAIDER, you'll know that this is no ordinary 2WD electric powered Dune Buggy. Look closer, check-out the fully independent suspension, geared diff (for power upgrades), oil-filled shocks and chrome spoked wheels. Designed from the ground-up to give you the edge, the all new RAIDER is made from tough aluminium and quality race proven composites. The RAIDER has undergone piles of testing to make sure it puts a smile on your face from the first moment. There's nothing old skool here! The RAIDER has designed-in performance and durability that no other buggy in this class can match, or even get close to! Supplied completely assembled with a factory painted body in this cool scheme, the RAIDER features the mighty Arrma AS-1 steering servo, Powerful 'Mega' 15T motor with matching hi-performance 'Mega' ESC as standard, simply add your choice of transmitter and receiver, plus a 6 cell, 7.2V Ni-MH battery & you're ready to hit the track!

- **ARTR 2WD electric powered Dune Buggy**
- **Race proven construction**
- **Fully independent suspension**
- **Geared differential**
- **Oil-filled shocks**
- **Powerful 'Mega' 15T motor**
- **Hi-performance 'Mega' ESC**
- **AS-1 steering servo**
- **Factory painted shell**

C-AR010 ARRMA Raider EP ARTR£156.99

High performance
'MEGA' 15T motor
and electronic
speed control.



Fully
independent
suspension with
quality oil-filled
shocks and springs

dBoots
'Dunerunner'
tyres & chrome
wheels.



SKILL LEVEL:



AMATEUR

ARRMA

WE ARE RADIO CONTROL

ARRMA is a new and exciting radio control car company whose aim is to design and manufacture the most exciting and cool cars available. Creating cars for all sectors and interests, from 1/10 electric and nitro, to 1/8 electric and nitro, realistic scale cars and totally new and original designs, this innovative company will give R/C fans reasons to become ARRMA fans, by enjoying the best R/C experience possible.

Coming Soon!

VORTEX



2DX10



**All Coming
in 2011!**

GRANITE



FURY



MOJAVE



ARRMA is a new brand, but the people behind it - the managers, designers, engineers, factory and suppliers - each have decades of experience to make sure everything about the product hits the mark. ARRMA is about "going for it!" and having fun. Whether you are a rookie or a seasoned R/C fan ARRMA will have a product for you!

O.S. MAX 21XZ-B

Designed with the club, 1/8th scale, off-road racer in mind, the Max 21XZ-B draws on many of the features developed for the top-of-the-line Speed 21XZ-B and has then been simplified technically to make a more cost-effective engine for everyday sport use. The Max 21XZ-B is still pumps out an amazing 2.55PS at 33000RPM so she's no slouch. The class leading throttle response is typically 'OS' from the type 21J2 carburettor.



L-OS12180 O.S. MAX 21XZ-B£224.99

Dimensions (mm):

A 37.0
B 21.0
C 65.6
D 45
E 101.9
F: 44
G: 31.6
H: 33.5
J: 86.3
S UNF 1/4-28

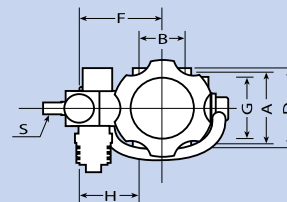
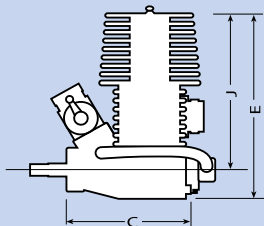

Displacement:	3.49cc (0.213cu.in)	Power Output:	2.55PS @ 33,000rpm
Bore:	16.27mm (0.641")	Practical RPM:	4,000 ~ 40,000 rpm
Stroke:	16.8mm (0.661")	Weight:	362g (12.52oz)

O.S. SPEED 21XZ-B

Developing on the 1/8th Off Road World championship winning engine of 2008, O.S. has now developed the latest generation engine called the Speed 21XZ-B. The Speed 21XZ-B is case in point. Featuring DLC coating, tungsten weighted and silicon filled crankshaft, the Ceramic rear bearing or the shape of the cylinder ports, everything has been developed to make the Speed 21XZ-B a step forward in performance.



L-OS12186 O.S. Speed 21XZ-B.....£359.99

Dimensions (mm):

A 37.0
B 21.0
C 64.5
D 45.0
E 101.6
F: 44.0
G: 31.6
H: 33.5
J: 86.3
S UNF 1/4-28

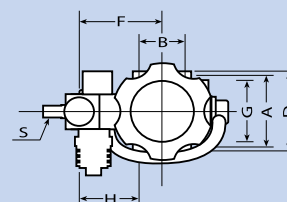
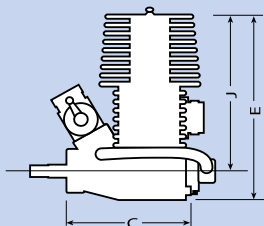

Displacement:	3.49cc (0.21cu.in)	Power Output:	2.6PS @ 34,000rpm
Bore:	16.27mm (0.64")	Practical RPM:	4,000 ~ 40,000 rpm
Stroke:	16.8mm (0.66")	Weight:	355g (12.52oz)

O.S. MAX 55HZ HYPER - LIMITED EDITION WITH PIPE

A special Limited Edition version of the fabulous Max 55HZ Hyper in stunning black external finish and matching black tuned silencer. For the flyer that demands that his model products a little more exclusive!

Both the engine and the silencer are engraved to show the Limited Edition nature of the pair and all of this comes at a price that is actually less than buying the standard engine and muffler together.

There will only ever be one batch in the UK!

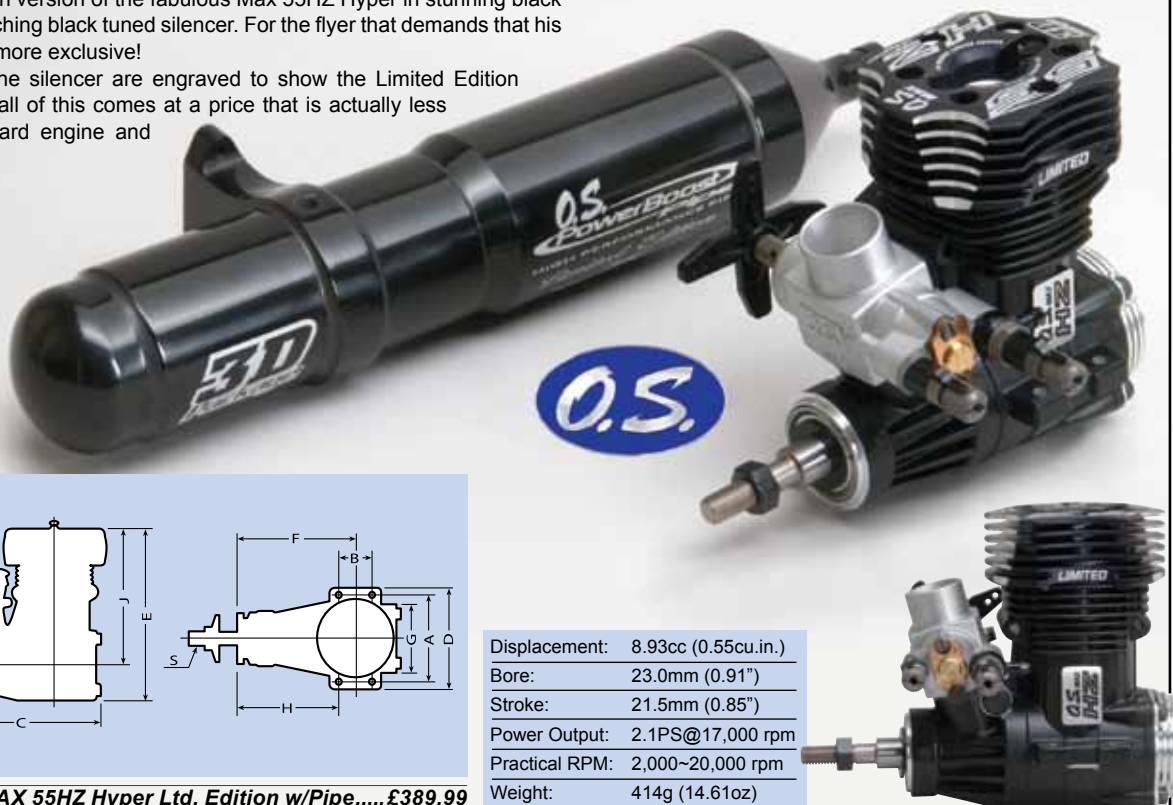

Dimensions (mm):

A 44.0
B 17.5
C 81.9
D 52.0
E 90.9
F: 51.6
G: 36.0
H: 42.85
J: 72.6
S UNF 1/4-28

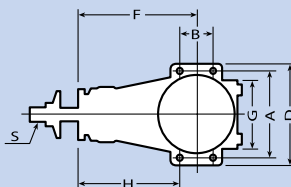
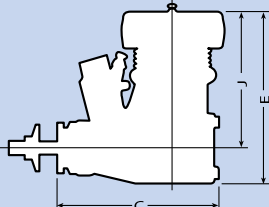

Displacement:	8.93cc (0.55cu.in.)
Bore:	23.0mm (0.91")
Stroke:	21.5mm (0.85")
Power Output:	2.1PS@17,000 rpm
Practical RPM:	2,000~20,000 rpm
Weight:	414g (14.61oz)

L-OS15637 O.S. MAX 55HZ Hyper Ltd. Edition w/Pipe.....£389.99

O.S. MAX 55HZ-R

The latest engine in the 600/50 helicopter class borrows much of its technology from the fabulous Max 91HZ-R, to provide class leading power under demanding 3D manoeuvres. The latest DRS system (Demand Regulator System) uses a crankcase pressure tap-off to pressurise the fuel tank via a one way valve. The pressurised fuel is then carefully regulated for optimum mixture no matter what demands are placed on it.

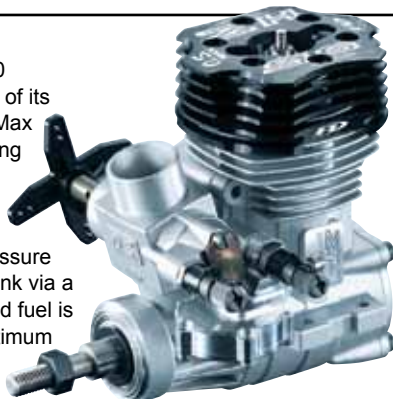

L-OS15650 O.S. MAX 55HZ-R£279.99

Dimensions (mm):

A 44
B 17.5
C 76.6
D 52
E 90.9
F: 51.6
G: 36
H: 42.85
J: 72.6
S UNF 1/4-28

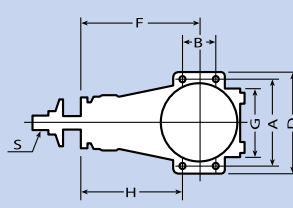
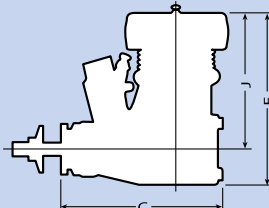

Displacement:	8.93cc (0.55 cu.in.)	Power Output:	2.1PS @ 17,000 rpm
Bore:	23.0mm (0.91")	Practical RPM:	2,000 ~ 20,000 rpm
Stroke:	21.5mm (0.85")	Weight:	408g (14.39oz)

O.S. MAX 65AX

Designed as a replacement for the long established Max 61FX, the new Max 65AX has all the features of the new AX series, such the same mounting bolt pattern and silencer bolt dimensions, making a direct replacement for most 61 class engines. The real bonus is more power and torque for the same basic external dimensions. Like all the AX series, cooling has been improved by the use of increased fin area and the new fin pack shape.

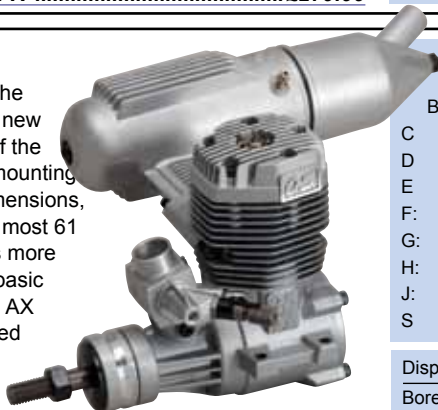

L-OS16521 O.S. MAX 65AX w/E-4010A Silencer.....£169.99

Dimensions (mm):

A 52
B 25
C 95.3
D 60
E 98.5
F: 66.6
G: 40
H: 54.1
J: 78.5
S UNF 5/16-24

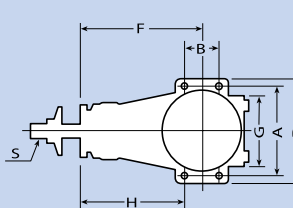
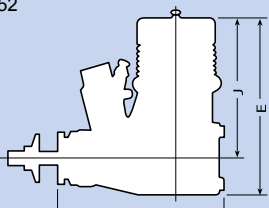

Displacement:	10.63cc (0.649cu.in.)	Power Output:	1.75PS @ 16,000 rpm
Bore:	24.0mm (0.945")	Practical RPM:	2,500 ~ 12,000 rpm
Stroke:	23.5mm (0.925")	Weight:	497g (17.53oz)

O.S. MAX 91HZ-R RING

This version of the Max 91HZ series utilises a completely different system for supplying and regulating the fuel supply to the carburettor and is called DRS (Demand regulator system). Unlike the Max 91HZ-PS, the Max 91HZ-R utilises a pressure bleed from the crankcase to pressurise the main fuel tank. The pressurised fuel feed is then regulated by a newly designed regulator that is well isolated from the heat of the engine and fed to the new 61E carburettor.



L-OS18640 O.S. MAX 91HZ-R Ring£349.99

Dimensions (mm):

A 52.0
B 25.0
C 83.0
D 61.0
E 102.7
F: 56.4
G: 43.0
H: 76.2
J: 81.2
S UNF 5/16-24

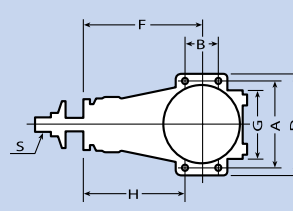
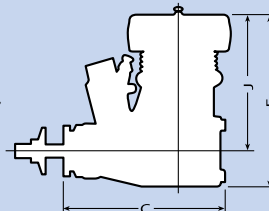

Displacement:	14.95cc (0.912 cu.in.)	Power Output:	3.4PS @ 15,000 rpm
Bore:	27.7mm (1.091")	Practical RPM:	2,000 ~ 16,000 rpm
Stroke:	24.8mm (0.976")	Weight:	625g (22.05oz)

O.S. MAX 91HZ WITH 61E CARB

Identical in most technical respects to the original Max 91HZ Ring engine but now with the latest 61E carburettor for an improved spread of power across the RPM range. Ideal for sports flying and F3C competition alike.



L-OS18650 O.S. MAX 91HZ w/61E Carb.....£294.99

Dimensions (mm):

A 52.0
B 25.0
C 93.3
D 61.0
E 102.7
F: 56.4
G: 43.0
H: 76.2
J: 81.2
S UNF 5/16-24

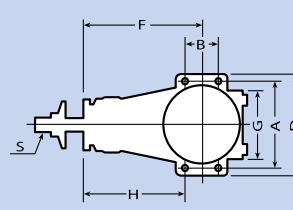
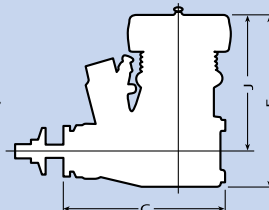

Displacement:	14.95cc (0.912cu.in)	Power Output:	3.4PS @ 15,000rpm
Bore:	27.7mm (1.091")	Practical RPM:	2,000 ~ 16,000 rpm
Stroke:	24.8mm (0.976")	Weight:	618g (21.82oz)



O.S. FS-95V

The first in a completely new series of four stroke engines aimed squarely at the sport and scale modeller. The styling is deliberately 'retro' and in keeping with the style of the very first O.S. four strokes. The original FS-120 had twin rocker covers and so do many full size engines in older aircraft. But 'retro' styling does not mean 'retro' technology! The FS-95V is a sophisticated piece of kit, delivering strong power and torque and offers a cost effective alternative to the FSa-81.

The 60P carburettor is a twin needle design for great throttle response and reliable idling. There is nothing worse than having your engine 'cough' at the wrong time when you really need a reliable response. The FS-95V will give you that piece of mind and respond just when you want it. That is why so many discerning modellers choose O.S. time after time!

There are many models designed for .61 2-strokes/.91 4-strokes and

the FS-95V was created with that in mind. She will fit in anywhere that an FS-91S does, so model compatibility is not an issue. The added benefit, is far better silencing from the new F-5050, baffled, twin chamber silencer.

Dimensions (mm):

A	52.0
B	25.0
C	89.0
D	61.0
E	119
F	54.0
G	42.6
H	54.0
J	97.5
S	UNF 5/16-24

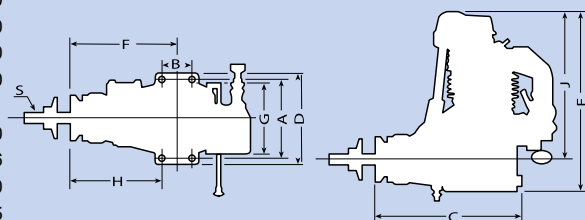

Displacement:	15.59cc (0.951cu.in.)	Power Output:	1.7PS @ 10,000 rpm
Bore:	29.0mm (1.142")	Practical RPM:	2,100 ~ 11,000 rpm
Stroke:	23.6mm (0.929")	Weight:	592g (20.88oz)

L-OS30900 O.S. FS-95V w/F-5050 Silencer £279.99



O.S. FR-420 SIRIUS 7

Sirius7

FR7-420

"For all passionate scale modellers"

Since 1986, many modellers have enjoyed the unique experience of owning and operating the fabulous FR5-300 Sirius five cylinder radial. Models have become bigger over the years and O.S. wanted to release a new radial engine to suit. The result is the gorgeous FR7-420. With 7 cylinders and a capacity of nearly 70cc, the FR7-420 offers a dramatic increase in both torque and power over its predecessor. The totally new cylinder heads are not just about style... they offer a more efficient design that contributes to the power output. That neat frontal appearance is maintained by keeping the single, dual needle carburettor at the back and hidden in the centre of the engine mount.

It would almost be a crime to hide it away in a cowl!

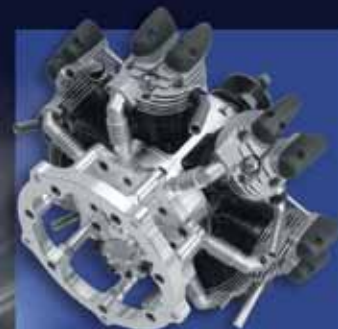

Only O.S. could go the extra mile and supply the Sirius 7 in this elegant presentation and storage case!



SPECIFICATION

Displacement:	7 x 9.95cc (0.607)
Bore:	24mm (0.945")
Stroke:	22mm (0.866")
Practical RPM:	1,500 ~ 7,000 rpm
Weight:	3.17Kg (111.71oz)

L-OS37010 O.S. FR7-420 Sirius 7 £3,449.99

O.S. FSA-155-P

The biggest engine in the 'Alpha' series has been designed with both aerobatic and scale modellers in mind. The pumped fuel system deals with the demands of aerobatic fliers who demand consistent power in any attitude and is tolerant to variations in fuel tank location.

With consistent fuelling, the Fsa-1555-P then goes about its business of delivering that stunning 2.6PS of power when you demand it. But that is only part of the story. The strong spread of torque down the RPM range allows a wide variation of propeller loads to suit both aerobatic and scale modellers alike by 'picking up' cleanly and strongly. With mounting dimensions identical to 1.20 class engines, fitting the FSA-155-P is pretty simple.

Dimensions (mm):

A	58.0
B	25.0
C	99.5
D	67.0
E	138.6
F	77.0
G	47.0
H	64.5
J	114.0
S	UNF 5/16-24

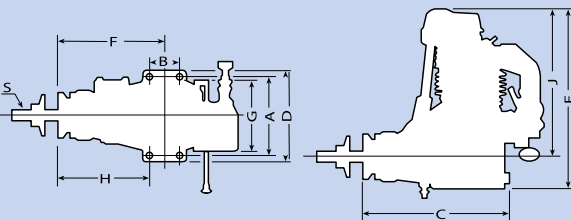

Displacement:	25.36cc (1.548cu.in)	Power Output:	2.6PS @ 10,000 rpm
Bore:	33.6mm (1.323")	Practical RPM:	2,500 ~ 10,000 rpm
Stroke:	28.6mm (1.126")	Weight:	805g (28.4oz)

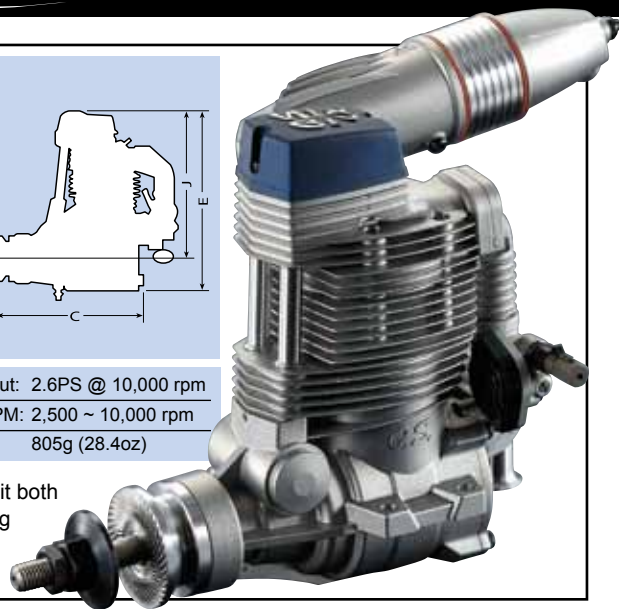

L-OS35430 O.S. Fsa-155-P..... £429.99

INTELLECT LI-PO CELLS

O-IT1S1P013025A1

Intellect**Two Cells per Pack!**

O-IT1S1P013025A2

High discharge rate, single-cell Li-Pos suitable for indoor and lightweight models. The first high discharge cells of this size, and with 130mAh capacity, you have great performance under load and long life at low currents. The cell's moulded nose built in plug make O-IT1S1P013025A1 suitable for the Nine Eagles Solo Pro, YAK54 and P-47D. O-IT1S1P013025A2 is suitable for the EF Helicopter Mini Stinger and Nine Eagles Draco.

Capacity:	130mAh
Max Discharge:	25C (6A)
Dimensions:	41 x 12 x 7mm
Weight:	4g

O-IT1S1P013025A1 Intellect 1S 130mAh 25C Li-Po(2pcs)N1..... £6.50

O-IT1S1P013025A2 Intellect 1S 130mAh 25C Li-Po(2pcs) N2..... £6.50

Capacity:	130mAh
Max Discharge:	25C (6A)
Dimensions:	36.5 x 12.43 x 5.7mm
Weight:	4g

**160mAh**

O-IT1S1P016025A

Two Cells per Pack!

A large capacity high discharge rate, single-cell Li-Po cell that is suitable for many indoor/lightweight models such as those from Kyosho or E-Flite. Its high discharge rate and 160mAh capacity means great performance under load and prolonged life at low currents. Fits the E-Flite charger (but not the Kyosho charger) but suitable for both E-Flite and Kyosho models.

O-IT1S1P016025A Intellect 1S 160mAh 25C Li-Po(2pcs) £7.75

INTELLECT 2S LI-PO BATTERIES

Capacity:	240mAh
Max Discharge:	25C (6A)
Dimensions:	36 x 20 x 13mm
Weight:	16g

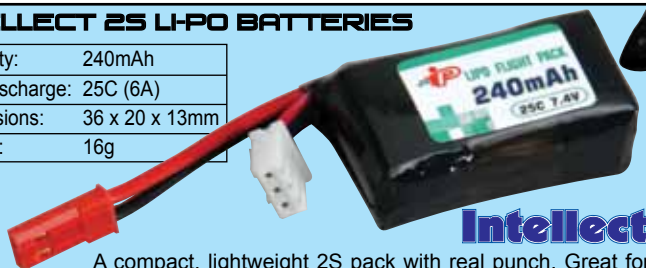
**Intellect**

A compact, lightweight 2S pack with real punch. Great for indoor and outdoor models alike. An ideal upgrade pack for the Nine Eagles Sky Eagle and Sky Runner.

O-IT2S1P024025A Intellect 2S 240mAh 25C Li-Po..... £8.25

RIPMAX MAIN BLADES

High quality helicopter main blades - available in a choice of glass fibre or carbon fibre suitable for both Sport and 3D uses. The internal construction is strong and optimised to take advantage of the immense strength that helicopter blades require. When combined with the carbon fibre external laminate, they become exceptionally rigid also. The distinctive white/black colour scheme identifies the carbon versions yet still maintains good visibility in flight.

The 325 size suits 450 class EP helicopters
The 430 size suits 500 class EP helicopters
The 550 size suits '30' class IC helicopters
The 600 size suits '50' class IC and 600 class EP helicopters



A-RMXCB325	Carbon Main Blades 325mm	£16.50
A-RMXCB430	Carbon Main Blades 430mm	£26.75
A-RMXCB550	Carbon Main Blades 550mm	£39.99
A-RMXCB600	Carbon Main Blades 600mm	£43.99
A-RMXGB325	GRP Main Blades 325mm	£9.25
A-RMXGB430	GRP Main Blades 430mm	£17.50
A-RMXGB550	GRP Main Blades 550mm	£22.50
A-RMXGB600	GRP Main Blades 600mm	£24.50

PRO-PEAK MINI MIZE DC CHARGER

11~18V
DC Input

**Mini
mize**
2AMP LI-PO BALANCE CHARGER



A compact, fixed 2A balance charger for 2 or 3 cell Li-Po packs. Operates from a 10-18V DC power source and has a durable, anodised, aluminium case to absorb those inevitable knocks!
Balancing current is 200mA and precision is 10mV. The balance ports are XH type.

FEATURES:

- Built-In Cell Balancer
- Balance During Charging
- Reverse Polarity Protection
- LED Charge & Balance Indicators
- Anodised Aluminium Alloy Case

SPECIFICATION:

- Battery Type - Li-Po
- Number of Cells - 2~3
- Input Voltage - 11~18V DC
- Charge Current - 2A
- Balancing Current - 200mA
- Balance Precision - 10mV
- Dimensions - 75 x 45 x 18mm
- Weight - 110g

O-IP3070 Pro-Peak Mini Mize DC Charger £15.50

PRO-PEAK PRIMA EQ

11~18V
DC Input

**PRO-PEAK
PRIMA EQ**



A purpose-designed, balancing charger/discharger for Lithium technology batteries only. It will accept both Li-Po and Li-Fe batteries in packs of 2 - 4 cells in series and charge them at up to 4A within a limitation of 35W from a 10-15V DC power source.

The Prima EQ can be a balancer, balance charger or balance discharger, you just need to select the correct parameter. The balancing and discharge current is set at 300mA maximum and the balance accuracy controlled to within 10mV. The clear, back-lit, LCD display shows all the necessary data during setup or operation.

FEATURES:

- Built-in Li-Po cell balancer
- High power & high performance circuit
- Balance cells during charge or discharge
- Input power monitor
- Reverse polarity & short circuit protection
- Lightweight, tough & attractive alloy case
- Clear, backlit LCD

SPECIFICATIONS:

- Battery Type: - Li-Po & Li-Fe
- Cell Count: - 2~4 cells
- Input Voltage: - DC 10~18V, 5.0A
- Charge Current: - 0.1~4.0A, 35W max.
- Discharge Current: - 300mA max.
- Balancing Current: - 300mA max.
- Balance Precision: - 10mV
- Display Resolution: - 0.001V
- Detect Precision: - 0.005V
- Dimensions: - 103 x 70 x 25mm
- Weight: - 130g

O-IP3080 Pro-Peak Prima EQ Charger £23.99

ABF ADVANCED BATTERY FACTORY

A range of economic, high performance Li-po batteries with the sport modeller firmly in mind. The range has been selected to suit the most popular models on the market and provide a cost effective solution to your electric power needs. Research was undertaken to ensure that these batteries lived up to the suppliers claims and that you get 'exactly what it says on the label', a good quality product with reliable performance.

- Ready to fit the connector of your choice
- Perfect for many RTF Foamies

Amazing Value!



O-ABF2S1P130025A	ABF 2S 1300mAh 25C Li-Po	£12.25
O-ABF2S1P400040C	ABF 2S 4000mAh 40C Car Li-Po	£56.25
O-ABF3S1P130025A	ABF 3S 1300mAh 25C Li-Po	£16.50

O-ABF3S1P220025A	ABF 3S 2200mAh 25C Li-Po	£20.50
O-ABF3S1P320025A	ABF 3S 3200mAh 25C Li-Po	£36.99
O-ABF4S1P220025A	ABF 4S 2200mAh 25C Li-Po	£27.75
O-ABF6S1P220025A	ABF 6S 2200mAh 25C Li-Po	£45.99

SKYRC IMAX E4 CHARGER

A simple, 12V input, 1 to 4 cell Li-Po charger with variable charge current from 0.1 to 4.5A (in 0.5A steps). The output/balance sockets are XH type and its compact size and flexibility of charging for many pack sizes make the SkyRC IMax E4 an attractive proposition for aero, heli, car and boat modellers alike.

- Microchip controlled technology for efficient charging
- Charge 1 to 4 cell Li-Po batteries
- Adjustable charge rate - 100mAh to 4500mAh
- Cell count automatically detected
- LED and alarm to indicate the charge status
- Short circuit protection on input and output



O-SKYCHE4 SkyRC IMAX E4 Charger £18.99

SKYRC IMAX B6 DUO CHARGER

What's the best way to improve the already great IMAX B6 Charger.... put two of them together! This variant of the B6 charger has 2 outputs allowing you to charge two batteries completely independently at the same time. This means less waiting and more flying!

- Discharge Current: 0.1 – 5.0A (2x 25W max)
- Charge Current: 0.1 – 10.0A (2x 200W max)
- Nicd/NiMH Cell Count: 1 – 18
- Li-XX Cell Count: 1 – 6
- DC Input: 11 – 18V

Length: 200mm
Width: 135mm
Height: 57mm
Weight: 727g



**Charge Two
Batteries at
Once!**



O-SKYCHB6D SkyRC IMAX B6 Duo Charger £132.99

SKYRC IMAX B6 ULTIMATE CHARGER

Based on the standard IMAX B6 charger but modified to pack one hell of a punch. With a whopping 200 Watts on tap this charger is designed to suit the demanding electric enthusiast, yet still retain the ease of use SkyRC are known for.

- Discharge Current: 0.1 – 5.0A (25W max)
- Charge Current: 0.1 – 10.0A (200W max)
- Nicd/NiMH Cell Count: 1 – 18
- Li-XX Cell Count: 1 – 6
- DC Input: 11 – 18V

Length: 150mm
Width: 116.5mm
Height: 53mm
Weight: 607g

**Massive
200
Watts!**



O-SKYCHB6U SkyRC IMAX B6 Ultimate Charger £66.50

ARROWWIND BRUSHLESS ESC



ARROWWIND

Arrowwind ESCs are built to extremely accurate standards and very high quality materials are used throughout. That quality results in predictable, high performance time after time. The setup of each ESC can be made using stick commands, or in a much more user-friendly way, with the optional program card. The LCD display on the card is easy to read and the program steps are logical. The program card has all the options written on it to save you always carrying the instructions! Each ESC comes pre-programmed for Li-Po cells as part of the default. All other battery types can be used by programming the exact low voltage cut-off value you require relative to the type of battery. You can of course use Li-Pos at a different cut-off value as well. By selecting the correct combination of parameters, these ESCs can be used for powered aircraft, gliders and helicopters alike.

Programmable Features:

- **Cut Off Voltage:** Low voltage protection threshold - the voltage threshold can be set within a range of 0~49.9V
- **Start Power Position Percentage:** (0%~29%)
- **Timing Mode:** Low/Mid/High/Highest
- **Brake Type:** Off/Soft/Hard
- **Start Mode:** Fast Start/Soft Start/Very Soft Start
- **Cutoff Type:** Soft-Cut/Cut-Off
- **Throttle Curve Mode:** CURVE1/CURVE2/CURVE3
- **Motor Rotation:** Forward and Reverse



BRUSHLESS ESC-3A

P-AWDFC0301



A very small and light ESC designed for single cell Li-Po use. Has no built in BEC function. Radio power is taken direct off the Li-Po (wiring diagram given in the instructions).

P-AWDFCPC Arrowwind Program Card for ESC £10.25

		Continuous Current	Maximum Current (10s)	BEC Type	Li-Po Cells	Ni-Xx Cells	Dimensions mm	Weight	S.R.P.
P-AWDFC0301L	Brushless ESC-3A	3A	4A	None	1	N/A	11 x 13 x 8	0.7g	£18.50
P-AWDFC0702L	Brushless ESC-7A	7A	9A	Linear	1-2	3-6	20 x 12 x 5	4g	£16.50
P-AWDFC1203L	Brushless ESC-12A	12A	15A	OPTO	1-3	3-10	22 x 17 x 7	7g	£17.50
P-AWDFC1803L	Brushless ESC-18A	18A	23A	Linear	2-3	5-10	16 x 28 x 9	22g	£18.50
P-AWDFC2504L	Brushless ESC-25A	25A	30A	Linear	2-4	5-12	46 x 28 x 9	25g	£20.50
P-AWDFC3004L	Brushless ESC-30A	30A	40A	Linear	2-4	5-12	50 x 28 x 12	34g	£23.50
P-AWDFC3505SW	Brushless ESC-35A(SW)	35A	40A	Switch	2-4	5-12	58 x 27 x 10	36g	£30.75
P-AWDFC4005SW	Brushless ESC-40A(SW)	40A	50A	Switch	2-5	5-14	58 x 27 x 10	36g	£34.75
P-AWDFC5005SW	Brushless ESC-50A(SW)	50A	65A	Switch	2-5	5-14	58 x 27 x 10	36g	£43.99
P-AWDFC6006SW	Brushless ESC-60A(SW)	60A	80A	Switch	2-6	5-18	58 x 27 x 15	51g	£51.99
P-AWDFC8006SW	Brushless ESC-80A(SW)	80A	100A	Switch	2-6	5-18	58 x 27 x 15	60g	£71.99
P-AWDFC8010HV	Brushless ESC-HV80A Opto	80A	100A	OPTO	2-10	5-36	71 x 55 x 20	160g	£149.99
P-AWDFC10006L	Brushless ESC-100A Opto	100A	120A	OPTO	2-6	5-18	70 x 55 x 20	160g	£102.99
P-AWDFC10010HV	Brushless ESC-HV100A Opto	100A	120A	OPTO	2-10	5-36	72 x 55 x 20	162g	£163.50

ARROWIND BRUSHLESS ESC

Arrowind have created a range of ESCs that caters for 1/10th and 1/8th scale cars in both on-road and off-road applications. The three sizes are 60A, 80A and 100A and all are the sensorless type. All will handle 2-4S Li-Po or 4-15S Ni-MH/Nicad and will provide a stable 5V/3A power supply from the switch mode BEC to the radio system. Programming of functions can be though the ESC or via the optional program card. An integral heatsink and cooling fan keeps the circuit temperature under control.

Features

- Brake Force (50, 75, 100%)
- Drag Brake (Zero, 5, 10, 15, 20%)
- Run Mode (Forward w/brake, forward/reverse, forward/reverse w/brake))
- Start Force (10, 15, 20, 23, 25%)
- Cell type (Auto or manual)
- Low Voltage Cutoff (2.5, 2.8, 3.1V)
- Timing (Low, Mid, High, Highest)
- Neutral Range (6, 8, 10%)
- Initial Brake Force (5, 10, 20, 30%)
- Reverse Force (25, 50, 75, 100%)

ARROWIND**Protection**

- Low Voltage
- Lost signal
- Overheat
- Self Check

P-AWDLC100**P-AWDLC100 Arrowind Brushless Car ESC-100A.....£86.99****P-AWDLC60 Arrowind Brushless Car ESC-60A£56.25****P-AWDLC80 Arrowind Brushless Car ESC-80A£71.50**

Electric flight just got even cheaper! This brand new range of Electronic Speed Controllers are suitable for both Li-Po and Ni-MH batteries and, despite their low, prices are programmable! From 10A to 110A and prices start at an amazing £13.99

Ripmax
DRAGON
SPEED CONTROLLERS

Amazing Value!

		Continuous Current	Maximum Current (10s)	BEC Type	BEC Output	Li-Po Cells	Ni-Xx Cells	Dimensions mm	Weight	S.R.P.
P-RMXD010	Dragon X 10A	10A	12A	Linear	5V/3A	2-3	4-10	40 x 23 x 6	16g	£13.99
P-RMXD015	Dragon X 15A	15A	18A	Linear	5V/3A	2-3	4-10	40 x 23 x 6	19g	£15.50
P-RMXD030	Dragon X 30A	30A	36A	Linear	5V/3A	2-3	4-10	48 x 23 x 10	30g	£19.50
P-RMXD045	Dragon X 45A	45A	51A	Switch	5V/3A	2-6	6-20	68 x 39 x 12.6	38g	£23.50
P-RMXD060	Dragon X 60A	60A	66A	Switch	5V/3A	2-6	6-20	68 x 39 x 12.6	42g	£28.75
P-RMXD075	Dragon X 75A	75A	81A	Switch	5V/3A	2-6	6-20	57 x 39 x 12.6	50g	£35.75
P-RMXD090	Dragon X 90A	90A	98A	Switch	5V/3A	2-6	6-20	68 x 39 x 6.5	80g	£51.15
P-RMXD110	Dragon X 110A	110A	120A	Switch	5V/3A	2-6	6-20	75 x 39 x 16.5	112g	£61.50

MICRO DV CAMERA - (2GB)

This tiny video camera is perfect for mounting to even small models for in flight recording of both video and audio, and offers amazing quality playback for a camera this small and light – only 20 grams! Charging the built-in battery is quick and easy from your computer via the included USB lead and the camera is supplied complete with 2GB Micro SD card as well as two different mounts, protective cover and full instructions on a mini CD.

- Compact, Lightweight Micro DV Camera
- Records Audio and 720x480 AVI Format Colour Video
- High Speed USB 2.0 Data Transfer
- USB Cable Included
- Mounting Clip and Bracket Included
- 30FPS Video Frame Rate
- Built-in Li-Po - 2-3 Hours Charge Time
- Charge From Your USB equipped PC

**Ripmax****MICRO DV CAMERA****2GB Micro SD Card Included!****P-MICRODV/2GB Micro DV Camera (2GB)£34.99**

FUTABA 3PRKA

Utilising Futaba's new FHSS 2.4Gz transmission system, this new 3 channel steerwheel system incorporates an internal transmitter aerial which allow a sleek new look, and comes complete with the new R203GF receiver. With the legendary Futaba quality and reliability this competitively priced system is perfect for those looking to buy their first radio, or to upgrade their RTR car or boat with this more advanced set. Supplied as standard for dry battery operation but can have Ni-MH rechargeable cells/packs fitted.



Features:

- 3rd Channel
- Servo Reverse
- Steering D/R
- EPA

2.4GHz FHSS

R203GF Specifications

Dimensions: 39 x 26 x 10mm
Weight: 14g



P-CB3PR/2-4G 3ch Combo 2.4G FHSS (Dry) R203GF.....£59.99

Futaba

FUTABA 3PL

The new 3PL 2.4GHz FHSS computer radio is a versatile three channel radio - with a fourth channel for special mixing. It is easy to program and its frequency-hopping FHSS technology offers dependable, hassle-free operation. 10 model memories as standard and supplied complete with the 14g R2004GF receiver.

- 3 Proportional Channels
- 1 Switched Channel
- Servo Reverse & End Point Adjust
- Steering Dual Rates
- Special Mixing for Crawlers
- Brake Mixing
- Internal Transmitter Aerial



R2004GF Specifications

Dimensions: 39 x 26 x 10mm
Weight: 14g
Voltage: 4.8V - 7.4V

P-CB3PL/2-4G 3ch Combo 2.4GHz FHSS (Dry) R2004GF.....£104.99

Futaba



FUTABA 4PL

Competition specification.... but sports system price! The new 4PL is perfect for all surface vehicles - from trucks to buggies, crawlers, touring cars and more. Its large - 128 x 64 dot - backlit LCD makes programming simple & 40 model memories ensure it's as practical as it is versatile. FHSS and S-FHSS selectable means that the 4PL can use existing FHSS receivers and the latest generation 6.8ms, high frame rate receivers such as the supplied R2104GF.

- 40 Model Memory
- 10 Character Model Naming
- Steering & Throttle EPA Expo and speed
- 128 x 64 Backlit LCD
- Throttle Acceleration, ATL and Idle-Up
- Digital Trims
- ESC Link

R2104GF Specifications

Dimensions: 39 x 26 x 10mm

Weight: 14g

Voltage: 4.8V - 7.4V



P-CB4PL/2-4G

4ch Combo 2.4GHz FHSS (Dry) R2104GF..... £234.99

Futaba

FUTABA 4PKS

This new system is a significant step forward from the class leading 4PK, and adds even greater speed with its reduced latency - being up to twice as fast as the 4PK! The already extensive and sophisticated programming is improved still further with up to 36 functions, including the new Crawler functions, on the adjustable contrast LCD screen. The included high voltage and ultra compact R614FF receiver offers exceptional performance and range, as well as full four function capability and utilises Futaba's class leading FASST transmission technology.

Suitable for both right and left handed drivers with its reversible wheel section, the wheel and trigger positions can also adjusted to fit the drivers hand perfectly. With features such as 40 model memory, A.B.S., start function, independent brake function, vibrating grip alert function etc, etc, the 4PKS is sure to become the standard by which all other car/boat radios are judged.

- 40 Model Memory
- Large LCD Screen
- ABS
- Independent Brakes
- Vibrating Grip
- Suitable for Left or Right handed Drivers

R614FF Specifications

Dimensions: 35 x 23 x 8.5mm

Weight: 7.8g

Voltage: 4.8V - 7.4V



P-CB4PKS/2-4G

4ch Combo 2.4GHz (Dry) R614FF..... £499.99

FUTABA T6J

This brand new 6 channel system from Futaba is probably one of the most significant new radios for some time, incorporating as it does both FHSS and S-FHSS transmission modes, which allows the use of a wide and ever expanding range of receivers, including the new micro R2005GF unit. Supplied as standard as a dry battery combo together with the matching R2006GS six channel receiver, the transmitter can also be fitted with individual AA rechargeable cells or 4/5 cell battery packs. Packed with features normally only seen on much more expensive systems, these include 15 model memories, large 127 segment LCD screen, both aircraft and helicopter mixing functions, etc, etc, as well as a rotary auxiliary control, something that is lacking in most of its competitors. To improve still further the ease of programming the 6JG is provided with 3 buttons and 1 edit key, thus avoiding the endless scrolling through screens more basic systems require.

- 15 Model Memory
- Reverse on all functions
- End Point Adjustment on all functions
- Sub Trim on all functions
- Dual rates
- Exponential
- Failsafe (all channels S-FHSS/ch3 FHSS)
- Throttle Cut
- Model Type
- Data Reset
- Timer
- Trainer function



Helicopter Specific

- Swash Type (Four)
- Swash/Throttle Mix
- Five Point Throttle Curve (Two)
- Five Point Pitch Curve (Three)
- Throttle Hold
- Hover Pitch
- Pitch/Rudder Mix
- Gyro Mix
- Swash Ring

Aircraft Specific

- Elevon Mix
- V-Tail Mix
- Flaperon Mix
- Flap Setting Mix
- Programmable Mix (Two)
- 2nd Aileron Channel



P-CB6JG2-4G/L 6ch Combo 2.4G FHSS (D) M2 R2006GS £149.99
P-CB6JG2-4G/R 6ch Combo 2.4G FHSS (D) M1 R2006GS £149.99

NEW FUTABA RADIO SYSTEMS

Many of Futaba's new radio systems utilise their FHSS (Frequency Hopping Spread Spectrum) transmission system, and this has now been expanded with the addition of the advanced S-FHSS system, which offers even greater capability, primarily failsafe on all channels and the option of high speed mode on channels 1-4. See chart for details of compatibility.

Feature	2.4GHz FHSS	2.4GHz S-FHSS
Number of Channels	4Ch.	8Ch.
High Speed Mode	N/A	Ch1. - Ch4.
Failsafe	Throttle	All Channels
Battery Failsafe	N/A	4PL(Ch2.) & 6JG/(Ch3.)

O = Compatible

TX	System	FHSS Receiver		S-FHSS Receiver	
		R603GF	R2004GF	R2104GF	R2006GS R2005GF
T2PL	FHSS	O	O	O	O
T3PL	FHSS	O	O	O	O
T4YFG	FHSS	O	O	O	O
T4PL	FHSS	O	O	O	O
	S-FHSS (Normal)	N/A	N/A	O	O
	S-FHSS (High Speed)	N/A	N/A	O (BLS & Digital Only)	O (Ch.1-4 Only)
T6JG	FHSS	O	O	O	O
	S-FHSS	N/A	N/A	O	O

Futaba

STOP PRESS

2.4GHz
FASST

FUTABA 8FG UPGRADE

An exciting new development by Futaba is the imminent release of a major software upgrade for the 8FG, which will dramatically improve the capabilities of this already extremely advanced radio. Due in early spring 2011, the new software will be available on our website, at <http://www.ripmax.com> and can be uploaded into the 8FG transmitter using an SD card. The 8FG was already one of the most sophisticated sets on the market, but this upgrade improves this still further, with features such as 14 channel operation (12 proportional and 2 On/Off), both aircraft and helicopter additional functionality, variable pitch propeller curve, as well as stick calibration and selectable user menu. Want a 14 channel radio for the price of an 8 - Futaba's amazing 8FG fits the bill!

Major Features:

- 14 channel operation
- Selectable wing type
- Swashplate sub-trim
- Swashplate pitch adjustment
- Variable Pitch Propeller
- Additional Condition Mixing
- Stick calibration
- User menu setting
- Gyro2/3 function setting
- Warning On/Off function

Download from <http://www.ripmax.com>

UPGRADE TO 14 CHANNELS FOR FREE

Upgrade Process



Open Battery Cover



Remove SD Card



Install SD Card in PC

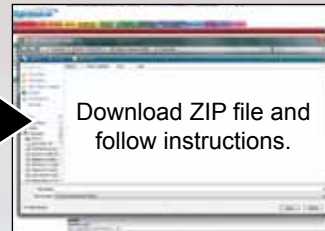

Download Software and Install

Download ZIP file and follow instructions.



Amazing Precision!



Futaba

GY701 GYRO AND GOVERNOR

Available in gyro only, governor only or combined gyro/governor formats, the new GY701 represents a quantum leap forward in technology. With Basic and Expert modes simplifying programming and reducing set-up time, the improved processing speeds of the GY701 reduce latency and give even faster and more accurate response, just what the expert pilot requires.

The OLED display is bright and easy to read, virtually whatever the light conditions and the governor, where used, is the final addition required for the perfect on-board radio package.

The full specification is too detailed to list here, but some of the features include:

- Small and lightweight
- S-Bus compatible
- Updateable firmware/software
- Basic/Expert modes
- Digital or Analogue servos can be used
- Ultra high-speed processing
- 3D/F3C mode selectable
- RPM range 1000-3000 (w/governor)
- Flight mode selectable
- MEMS (Micro Electro Mechanical System) technology
- OLED (Organic Light Emitting Display) for ease of reading
- Advanced PID control algorithm

Available in 3 Formats!

P-GY701/GOV	Governor GY701.....	£112.99
P-GY701/GYRO	Gyro Piezo GY701 (AVCS).....	£204.99
P-GY701/GYRO/GOV	Gyro Piezo GY701 (AVCS) + Governor.....	£254.99

FUTABA GY750

The amazing new GY750 combines a super fast response 3 axis gyro and governor into one tiny and lightweight unit. Developed as the perfect system for the increasingly popular flybarless helicopters, the GY750 has 3D and F3C modes and is also compatible with Futaba's S-Bus system, reducing the on-board radio size and weight still further. Utilising an OLED display for improved brightness and contrast, there are both Basic and Expert editing menus, and the software is updateable via a CIU-2 USB adapter.

Main Features:

- Advanced adaptive PID operation
- Miniature low profile sensor

Cyclic Functions:

- Full Flybarless functionality
- Support 5 Flybarless Swash modes

Yaw Function

- Wide operation dynamic ranges of up to +/- 1,200 degrees/sec
- Three servo types supported
- F3C/3D modes
- Yaw/Cyclic (Fore/Aft) mix
- Newly developed algorithm for improved pirouetting and yaw control



Governor Function

- Fastest possible operation
- Wide RPM range (1,000 ~ 3,000 RPM)
- Digital and analogue servo operation
- RPM/Yaw compensation rate
- Governor/RPM limit modes
- Newly developed algorithm for improved RPM controllability

P-GY750	GY750 Gyro 3-Axis/Governor.....	£279.99
----------------	--	----------------

6203SB + GY750

Also Available with the Futaba 6203SB, details on the next page.



**FUTABA 2036F
3CH RX 2.4GHZ FHSS**

Supplied as standard with the new 3PRKA radio system, the R2036F receiver utilises Futaba's new S-FHSS transmission system for ultimate reliability and interference rejection qualities.

Weight: 14g	Channels: 3
Dimensions: 39 x 26 x 10mm	

P-R2036F/2-4G**3ch Rx 2.4GHz FHSS.....£34.99****FUTABA 2104GF
4CH RX 2.4GHZ FHSS**

Able to function in both FHSS and S-FHSS modes, this new and low cost four channel receiver can be used with a wide range of Futaba transmitters, including 2PL, 3PL, 4PL, 4YFG and 6JG and can be operated with up to 7.4V battery packs. Using Brushless or Digital servos enables S-FHSS (high-Speed) usage.

Weight: 8g	Channels: 4
Dimensions: 39 x 26 x 10.1mm	

P-R2104GF/2-4G**4ch Rx 2.4GHz FHSS (Surface).....£44.99****FUTABA 614FF
4CH RX 2.4GHZ**

Capable of operation on up to 7.4v, the new and exceptionally compact R614FF FASST receiver is ideal for use with the high voltage servos becoming more and more popular, and has been specifically developed for use with Futaba's 4PK and 4PKS transmitters. It utilises Futaba's unique FASST technology to give the ultimate in clear, interference free operation.

Weight: 7.8g	Channels: 4
Dimensions: 35.1 x 23.2 x 8.5mm	

P-R614FF/2-4G**4Ch Rx 2.4GHz (FASST).....£109.99****FUTABA 2005GS
5CH RX 2.4GHZ FHSS**

(Image Shown - Artist's Impression)

This new 5 channel receiver is perfect for all type of park fly models, both fixed wing and helicopters. Weighing only 4 grams and with extremely compact dimensions this new FHSS receiver is going to be very popular! (Photographic sample not available at time of going to print).

Weight: 4g	Channels: 5
Dimensions: 39 x 21.6 x 8.2mm	

P-R2005GS/2-4G**5ch Rx Micro 2.4GHz FHSS (Air).....£29.99****FUTABA 2006GS
6CH RX 2.4GHZ FHSS**

Supplied with the new 6JG radio set, the 6 channel R2006GS full range receiver is both small and light, and uses Futaba's advanced FHSS transmission system for superior interference rejection. It can be used together with a wide range of Futaba transmitters, including 2PL, 3PL, 4PL, 4YFG and 6JG and can operate as both FHSS and S-FHSS.

Weight: 7.8g	Channels: 6
Dimensions: 43 x 25 x 9mm	

P-R2006GS/2-4G**6ch Rx 2.4GHz FHSS (Air).....£39.99****FUTABA 6108SB
8-18CH RX 2.4GHZ**

A compact full range FASST receiver, the R6108SB functions in both standard PWM mode where it outputs 8 channels or in S-Bus model where it outputs 18 channels.

Weight: 13.8g	Channels: 8 (PWM)/18 (S-Bus)
Dimensions: 24.9 x 47.3 x 14.3mm	

P-R6108SB/2-4G**8/18ch Rx (S-Bus) 2.4GHz.....£132.99****FUTABA 6203SB
3-18CH RX 2.4GHZ**

Primarily developed for helicopter usage but equally suitable for fixed wing models, this tiny new full range FASST receiver weighs only 7.2g, but in S-Bus mode it offers 18 channel output! (3 channels in PWM mode).

Weight: 7.2g	Channels: 3 (PWM)/10 (S-Bus)
Dimensions: 22.5 x 37.4 x 9.3mm	

P-R6203SB**3/8ch Rx (S-Bus) (HV) 2.4GHz.....£69.99****6203SB + GY750**

Combine the best and save money! The superb new GY750 3-axis gyro/governor and the micro but full range R6203SB receiver are put together in this value for money combination.

P-R6203/GY750**3/8ch Rx 2.4GHz/GY750 Combo .£339.99****FUTABA 6208SB
8-18CH RX 2.4GHZ**

Almost identical to the R6108SB receiver, the R6208SB receiver has been developed for use with 7.4V batteries and high voltage servos, and as such does away with the need for a voltage regulator.

Weight: 13.8g	Channels: 8 (PWM)/18 (S-Bus)
Dimensions: 24.9 x 47.3 x 14.3mm	

P-R6208SB/2-4G**8/18ch Rx (S-Bus) (HV) 2.4GHz.....£134.99**

FUTABA S-BUS CHANNEL PROGRAMMER

The Channel Setting Programmer is used to input into a programmable servo or decoder lead the correct channel number for operation on an S-Bus system, so that the servo/decoder lead accepts only that information that relates to it. Operation is very simple and requires only the addition of a receiver battery.



P-SBC-1 S-Bus Channel Setting Programmer..... £23.99

FUTABA S-BUS 4-WAY TERMINAL

This very useful component with four interconnected sockets enables four leads, servos or batteries to connect to this one low cost unit. Multiple mounting lugs allow great flexibility in installation.

P-SBC-4TERM

S-Bus 4-Way Terminal Block..... £5.75

FUTABA S-BUS HUB LEADS

Available in four lengths ranging from 300mm to 1500mm, these are the standard S-Bus leads used to connect to the receiver and to allow the connection of S-Bus programmable servos. The hub leads have a single plug at the end that connects to the receiver and a triple socket at the other, which can in turn have further hub leads, decoder leads, or even a receiver battery connected to the various sockets.



P-SBC-HUB1000	S-Bus Hub Lead (1000mm).....	£23.50
P-SBC-HUB1500	S-Bus Hub Lead (1500mm).....	£24.50
P-SBC-HUB300	S-Bus Hub Lead (300mm).....	£20.50
P-SBC-HUB500	S-Bus Hub Lead (500mm).....	£21.50

FUTABA S-BUS SERVO DECODERS

These decoder leads are used so that non programmable servos can also be utilised with the S-Bus system, with the SBD lead decoding the digital signal and converting it into conventional output so that standard, non-programmable servos will function correctly. With various lengths available, the SBD leads require programming in a similar manner to the programmable servos, either by the SBC-1 Channel Changer, or by the CIU-2 USB Adapter.



P-SBD-1/1100	S-Bus Servo Decoder (1100mm).....	£44.99
P-SBD-1/1600	S-Bus Servo Decoder (1600mm).....	£45.99
P-SBD-1/400	S-Bus Servo Decoder (400mm).....	£43.99

FUTABA HIGH VOLTAGE SERVOS

30S1HV HV SERVO

A competitively priced high voltage digital servo offering good speed and torque figures, with 3-pole motor for general applications.

Torque:	10.5Kg.cm (7.4V)
Speed:	0.16 sec/60 deg (7.4V)
Dimensions:	40 x 20 x 38mm
Weight:	49g



SBL156HV HV SERVO

High performance standard size servo which offers excellent speed and power, making it ideal for larger models and those with heavy flight loads.

Torque:	21.0Kg.cm (7.4V)
Speed:	0.12 sec/60 deg (7.4V)
Dimensions:	40 x 20 x 36.8mm
Weight:	66g



SBL255HV HV SERVO

High performance standard size servo developed primarily for 3D and F3C helicopter usage but also suitable for many other applications.

Torque:	12.0Kg.cm (7.4V)
Speed:	0.08 sec/60 deg (7.4V)
Dimensions:	40 x 20 x 36.8mm
Weight:	60g



SBL157HV HV SERVO

The most powerful Futaba servo currently available, yet still standard sized, making this servo the only choice for the highest performance jets and other models where weight and size of the servos are restricted yet ultimate speed and power are required.

Torque:	37.0Kg.cm (7.4V)
Speed:	0.11 sec/60 deg (7.4V)
Dimensions:	41 x 21 x 38mm
Weight:	77g



FUTABA HIGH VOLTAGE SERVOS

Not content with having probably the most advanced and comprehensive range of servo available, Futaba have now developed the first in a new range of high voltage servos. Designed to operate directly from 2 cell (7.4v) Li-Po battery packs without requiring a regulator, there are three Brushless servos and one standard servo due for release in early 2011. Offering the ultimate in speed and power, these high voltage servos are perfect for the most demanding applications in jets, IMAC aircraft and large helicopters.

Designed for 7.4 volt usage but can also operate on 6.0 volts.

P-S3051HV	Servo HV Digital - 0.15s/ 18.0Kg.....	£39.99
P-SBL156HV	Servo HV Brushless - 0.15s/18.0Kg.....	£119.99
P-SBL157HV	Servo HV Brushless - 0.14s/31.0Kg.....	£149.99
P-SBL255HV	Servo HV Brushless - 0.10s/10.6Kg.....	£119.99

FUTABA SERVOS

S3016 MINI M/GEAR SERVO

This new mini servo is primarily designed for small EP/GP aircraft and gliders, the metal gears being particularly useful for flap functions on gliders where shocks may damage plastic gears.

Torque:	4.2 Kg/cm (6.0V)
Speed:	0.20 sec/60° (6.0V)
Dimensions:	31 x 16 x 31mm
Weight:	34g



P-S3016 Servo Mini Metal/Gear 0.20s/4.2Kg £61.99

S3114 SUB-MICRO SERVO

A high speed micro servo weighing in at only 7.8g that is ideally suited to small electric powered aircraft and helicopters. Capable of operation on either 4.8 or 6.0 volts.

Torque:	1.7 Kg/cm (6.0V)
Speed:	0.09 sec/60° (6.0V)
Dimensions:	21.8 x 11 x 19.8mm
Weight:	7.8g



P-S3114 Servo Sub-Micro 0.10s/1.6Kg £18.50

FUTABA S-BUS SERVOS

S3171SB MINI S-BUS/PWM SERVO

Smallest of the S-Bus programmable servos, the S3171 can also operate with conventional receivers, is twin ballraced, has metal gears and is suitable for a wide range of small to medium sized aircraft and helicopters.

Torque:	3.7 Kg/cm (4.8V)
Speed:	0.24 sec/60° (4.8V)
Dimensions:	30 x 10.8 x 29mm
Weight:	20.5g



P-S3171SB Servo Mini S-Bus/PWM - 0.24/3.7Kg £56.25

S9072SB STD S-BUS/PWM SERVO

Standard sized, the S9072SB is twin ballraced for improved precision, and can operate with S-Bus and standard receivers, being developed for aircraft, helicopter and car applications.

Torque:	8.7 Kg/cm (6.0V)
Speed:	0.10 sec/60° (6.0V)
Dimensions:	40 x 20 x 36.6mm
Weight:	57g



P-S9072SB Servo Std S-Bus/PWM - 0.10/8.7Kg £86.99

Futaba's new S-Bus servos have been developed to be the ultimate in servos,

being fully programmable and capable of direct connection to the unique S-Bus system, which dramatically simplifies complicated radio installations and reduces the multiplication of extension leads otherwise required. In addition to this, these servos can also be used conventionally, with standard PWM (Pulse Width Modulation) receivers and radio installations.



S9071SB MINI S-BUS/PWM SERVO

The S9071SB can operate with S-Bus or conventional receivers, and is usefully smaller than standard sized servos, but still incorporates twin ballraces for smooth functioning and precise control. It is ideally suited to electric cars and mid sized aircraft and helicopters.

Torque:	4.6 Kg/cm (6.0V)
Speed:	0.11 sec/60° (6.0V)
Dimensions:	35.5 x 15 x 28.6mm
Weight:	25.8g



P-S9071SB Servo Mini S-Bus/PWM - 0.11/4.6Kg £71.99

S9074SB STD S-BUS/PWM SERVO

For more severe applications this servo is the perfect choice. Compatible with S-Bus or standard receivers, it offers both high power and speed, and features like twin ballraces, water resistance and a aluminium middle case.

Torque:	20.0 Kg/cm (6.0V)
Speed:	0.17 sec/60° (6.0V)
Dimensions:	40 x 20 x 37mm
Weight:	63g



P-S9074SB Servo Std S-Bus/PWM - 0.14/20.0Kg £121.99

S9075SB STD S-BUS/PWM SERVO

The most powerful S-Bus programmable servo available, the new S9075SB servo is exceptionally powerful, offering over 30 Kg.cm torque, so is perfect for the most demanding applications.

Torque:	30.6 Kg/cm (6.0V)
Speed:	0.14 sec/60° (6.0V)
Dimensions:	41 x 21 x 37mm
Weight:	71g



P-S9075SB Servo Std S-Bus/PWM - 0.14/31.0Kg £129.99

**A 2.4GHz Combo
for Under £40!**



Saturn

2.4GHz Radio Control System

A range of high performance 2.4GHz radio systems with an incredibly low price! Perfect for receiver-ready models as they are supplied without servos. A full-range, six channel receiver is supplied as standard.

- Interference-Free 2.4GHz Technology
- 4 Channel Digital Proportional Radio
- Servo Reversing on all Channels
- Battery Condition LEDs
- Lightweight 6 Channel Receiver

4 CHANNEL

2.4GHz

FHSS Radio Control System

P-SATRAD4 Saturn 4Ch Combo 2.4GHz FHSS.....£39.99



Saturn

2.4GHz Radio Control System

**Incredible
Value!**

Like the 4 channel system above, the Saturn 5 comes complete with a lightweight six channel receiver but without servos so you can choose your own or use with one of the many of today's receiver-ready models. Additional fifth channel is ideal for controlling lights, retracts, flaps and more.

- Interference-Free 2.4GHz Technology
- 5 Channel Digital Proportional Radio
- Servo Reversing on 4 Primary Channels
- Channel 5 Switch
- Battery Condition LEDs
- Lightweight 6 Channel Receiver

5 CHANNEL

2.4GHz

FHSS Radio Control System

P-SATRAD5 Saturn 5Ch Combo 2.4GHz FHSS.....£44.99





Saturn

2.4GHz Radio Control System

With four proportional and two switched channels, this versatile 6 channel combo even features a trainer function! Amazing value for money - there can't be a better or more cost effective way to complete a receiver-ready model.

- Interference-Free 2.4GHz Technology
- 6 Channel Digital Proportional Radio
- Servo Reversing on 4 Primary Channels
- Channel 5 and 6 Switches
- Battery Condition LEDs
- Lightweight 6 Channel Receiver
- Trainer System





Incredible Value!





P-SATRAD6
Saturn 6Ch Combo 2.4GHz FHSS..... £54.99

2.4GHz

6 CHANNEL

FHSS Radio Control System

SATURN TRAINER LEADS

Two trainer leads for the 6 channel Saturn radio to connect to an additional 6 channel Saturn transmitter and many Futaba transmitters. For full compatibility details, please see the Ripmax website at www.ripmax.com

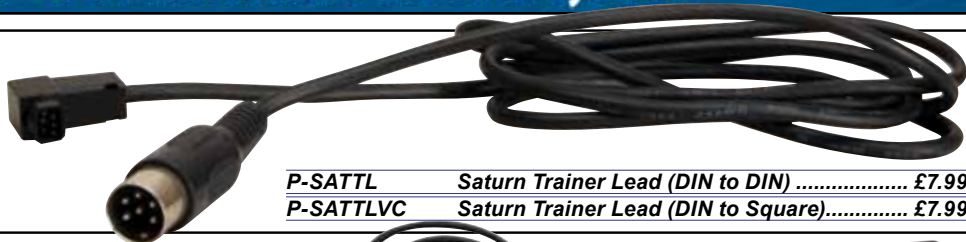

P-SATTL Saturn Trainer Lead (DIN to DIN) £7.99
P-SATTLVC Saturn Trainer Lead (DIN to Square)..... £7.99

SATURN 6CH RECEIVER 2.4GHz FHSS

A lightweight, full range, 2.4GHz FHSS receiver for all model applications. Standard in all 4, 5 and 6 channel Saturn radio systems.

Channels:	6
Voltage:	4.8 - 6V
Dimensions:	44 x 23 x 14mm
Weight:	9g



P-SATRX6 Saturn 6Ch Receiver 2.4GHz FHSS..... £19.99

SATURN 3Kg STANDARD SERVO

A reliable and cost effective standard size servo. Offering generous levels of speed and torque for either 4.8V or 6.0V operation.

Torque:	3.5 Kg/cm (6.0V)
Speed:	0.12 sec/60° (6.0V)
Dimensions:	36.4 x 20 x 36mm
Weight:	36g



P-SATS010 Saturn 3Kg Standard Servo..... £5.15

SATURN 12Kg SAIL WINCH SERVO

Perfect for applications that demand a "proper" sail winch, the new Saturn drum style winch combines a full 12Kg of torque at an impressive low price!

Torque:	12 Kg/cm (6.0V)
Speed:	1.45 sec/360° (6.0V)
Dimensions:	59.5 x 29.5 x 55mm
Weight:	72g



P-SATS100SW Saturn 12Kg Sail Winch..... £49.99

New Power

SERVO

Incredible Value!

A new range of high performance servos for the budget conscious modeller that demands a lightweight, great resolution and high torque servo that doesn't break the bank. New Power gives you all of this and more!

With prices starting at just £4.99 for the 9 gram XL-9, you really can't go wrong.



XL-16HM METAL GEAR

Specifications

Speed: 0.11sec/60°
Torque: 3.5kg/cm
Size: 29.5 x 11.6 x 30.2mm
Weight: 17.0g
Voltage: 4.8~6.0V

**Spare Horns
and Mounting
Hardware
Included with all
Servos!!**



XL-9HM METAL GEAR

Specifications

Speed: 0.10sec/60°
Torque: 2.5kg/cm
Size: 23.2 x 12.0 x 24.8mm
Weight: 10.0g
Voltage: 4.8~6.0V



XL-3.7

Specifications

Speed: 0.08sec/60°
Torque: 0.55kg/cm
Size: 19.8 x 8.2 x 22.0mm
Weight: 3.7g
Voltage: 4.8~6.0V



XL-2

Specifications

Speed: 0.09sec/60°
Torque: 0.23kg/cm
Size: 16.3 x 8.2 x 17mm
Weight: 2.0g
Voltage: 4.8~6.0V



XL-17HMB BB-METAL GEAR

Specifications

Speed: 0.10sec/60°
Torque: 3.5kg/cm
Size: 29.5 x 11.6 x 30.2mm
Weight: 17.5g
Voltage: 4.8~6.0V



XLD-17MB BB-METAL GEAR

Specifications

Speed: 0.055sec/60°
Torque: 2.0kg/cm
Size: 29.5 x 11.6 x 30.2mm
Weight: 17.5g
Voltage: 4.8~6.0V



XL-9HMB BB-METAL GEAR

Specifications

Speed: 0.10sec/60° (6V)
Torque: 3.5kg/cm (6V)
Size: 23.2 x 12 x 24.8mm
Weight: 11g
Voltage: 4.8~6.0V



XLD-9HMB BB-METAL GEAR

Specifications

Speed: 0.10sec/60° (6V)
Torque: 3.5kg/cm (6V)
Size: 23.2 x 12 x 24.8mm
Weight: 11.0g
Voltage: 4.8~6.0V

P-NEWXL02	New Power XL-2.0 Servo	£8.25
P-NEWXL037	New Power XL-3.7 Servo	£6.99
P-NEWXL09	New Power XL-9 Servo	£4.99
P-NEWXL09HM	New Power XL-09HM Servo	£6.99
P-NEWXL09HMB	New Power XL-09HMB Servo	£8.50

P-NEWXL16HM	New Power XL-16HM Servo	£8.99
P-NEWXL17HMB	New Power XL-17HMB Servo	£10.99
P-NEWXLD09HMB	New Power XLD-09HMB Digital Servo	£9.99
P-NEWXLD17MB	New Power XLD-17MB Digital Servo	£13.99

SATELLITE EXTENSION LEADS

A new range of lightweight Satellite Extension Leads that allow you to place a satellite receiver in a convenient place in your model. Available in a variety of lengths to suit the application - from 23cm to 120cm.



P-SSEL023	Satellite Ext. Lead (9in) 23cm.....	£1.50
P-SSEL030	Satellite Ext. Lead (12in) 30cm.....	£1.50
P-SSEL045	Satellite Ext. Lead (18in) 45cm.....	£1.75
P-SSEL060	Satellite Ext. Lead (24in) 60cm.....	£1.99
P-SSEL075	Satellite Ext. Lead (30in) 75cm.....	£1.99
P-SSEL090	Satellite Ext. Lead (36in) 90cm.....	£2.15
P-SSEL120	Satellite Ext. Lead (48in) 120cm.....	£2.15

EZE-KOTE FINISHING RESIN

A new laminating and finishing resin for balsa and foam models, Eze-Kote is a single part water based foam -safe, low odour, resin alternative to epoxy. Simply brush onto balsa and light glass cloth to create a tough, ding and fuel resistant film that can be sanded easily and painted after just 15 to 20 mins. 75ml covers approx 1m² in a single coat.



S-SE51

Eze-Kote Finishing Resin£12.25

500ml

TISSUE PASTE - 100ML

Formulated paste for bonding tissue used on traditional model aeroplanes. The formulation allows delicate tissue paper to be placed onto airframes and smoothed without tearing. Dries clear.

S-SE50 Tissue Paste - 100ml.....£4.25



TY1 XILICA POWDER - 30G

A free-flowing, high-tech powder that has the amazing ability to actually strengthen joints when mixed with Epoxy resins. It is not micro-balloons and behaves in a totally different way. Ideal, for extra strength joints in Epoxy glass fuselages etc. Not recommended for mixing with other types of glue/resins.

S-RMXX01

TY1 Xilica Powder - 30g£4.25



LIQUID GRAVITY METAL SHOT BALLAST

A non-toxic metal shot weighting system. Perfect for pouring into small cavities then setting in place with adhesives such as Roket Card Glue, R/C Modellers Glue, or Speed Epoxy. Ideal for adjusting the balance point of model aircraft, balancing wings and adjusting the ballast in model boats. Model railway enthusiasts can also use liquid gravity to improve the electric conductivity and stability of rolling stock. Supplied in a 240g pack.

Uses:

- Adjust centre of gravity on R/C model planes
- Improve model railway drive friction, conduction & stability
- Add ballast to model boats

S-SE49 Liquid Gravity Metal Shot Ballast.....£8.25



Back by popular demand! A limited edition of the famous Saturn V that sent man to the moon. The Estes Saturn V is one of the finest 1/100 scale models kits ever produced. Scaled from official NASA drawings, the finished model is 43.25 inches tall and lifts off to about 150 feet on one D12-3 engine.

This Made in the USA kit now features precision laser cut centring rings and a moulded Apollo capsule, escape tower and main engine display nozzles that remove easily for flight.

The Saturn V is recommended for ages 18 and up with adult supervision for those under 18. Skill Level 4.

ESTES

Length:	1100mm (43.25")
Diameter:	100mm (3.94")
Weight:	311.8g (11 oz.)
Altitude:	168m (150')
Rocket:	D12-3 (Req.)

D-ES2157
Kit Saturn V.....£102.99

MADE IN USA

P-51D MUSTANG



FLYING LEGENDS P-51D MUSTANG

Want to fly a large scale warbird? Does it have to be fully composite, and professionally painted? Like the idea of having the air operated retracts pre-installed, as well as the gear doors, which have the operating air rams pre-fitted? Hate hinging control surfaces, so prefer these to be pre-hinged - well we're pleased to be able to offer a brand new P-51D Mustang that fulfils all these needs and more. With a massive 99" (2515mm) wingspan and designed to suit 85cc petrol engines the new Flying Legends P-51 is fully moulded from advanced composites, using epoxy/glass and carbon for the ultimate in strength combined with minimum weight. Available in various versions, ranging from the airframe only, through a version with the gear doors fitted and air rams installed, through to a complete model including pre-installed air up/down retracts (main and tail) fitted with scale oleos, and specially produced aluminium main wheels plus tyres and tailwheel, air system ancillaries etc, etc. To enable easy completion and the perfect finished model optional accessories are also available, comprising a machined from solid aluminium spinner, completely finished scale cockpit and a specially developed internal muffler that due to its large volume and advanced design is both highly effective at reducing noise yet minimises loss of RPM. Assembly is incredibly quick, just radio, engine and ancillaries to install. Although it is possible to fit a range of engines the P-51 has been developed around the DA85 and BH85cc engines, both of which provide ample power to fly the Mustang superbly. Talking of flying characteristics, you will be amazed by just how well this model flies - we were! Take-off is simple, flying performance truly excellent, slow speed handling with the built-in washout is extremely benign, whilst the landing approach really could not be easier, the Mustang being exceptionally stable and predictable on finals with gear and flaps down. Aerobatics are a joy to perform, the large size and relatively low weight make for a smooth yet manoeuvrable model, and the appearance in the air is fantastic - don't miss out, buy and fly one, you'll be glad you did!

Q-FL100 Flying Legends P-51D Mustang (85cc)£1499.99

Q-FL100/B Flying Legends P-51D Mustang w/Ftd Hardware .. £1699.99

Q-FL100/C Flying Legends P-51D Mustang w/Ftd Retracts£1999.99

OPTIONAL ACCESSORIES



Superb detailed pre-assembled and pre-painted scale cockpit specifically for the Mustang

Q-FL100/SC P-51 Scale Cockpit £149.99



Finish your Mustang off with this superb, machined from solid, aluminium spinner

Q-FL100/SP P-51 Spinner £99.99

This large volume, quiet and effective internal silencer has been developed specifically for DA and BH 85cc engines and mounts totally inside the cowl



Q-FL85/SIL P-51 Internal Silencer £199.99



Scale machined alloy main wheels and moulded tyres add the finishing touches. (Included in Q-FL100/C)

Q-FL100MW P-51 Main Wheel £149.99

Q-FL100RW P-51 Rear Wheel£24.99



Wingspan:	2515mm (99")
Length:	2159mm (85")
Engine:	75 - 85cc Petrol
Radio:	6 - 8 Channel
Servos:	8 - 9 Servos

Due to the specialised nature of the P-51 it will only be available from a limited number of model shops, details of these will be available at www.ripmax.com



This Catalogue has been produced entirely
in-house by the Ripmax Graphics Department.

Published by:

Ripmax Ltd,
241 Green Street,
Enfield,
EN3 7SJ.
Tel: +44 (0) 20 8282 7500
Fax: +44 (0) 20 8282 7501
www.ripmax.com

Designed and Created by:

Bob Petrie, Darren Forrest and Alan Wood

Compiled by:

Nick Moss, Mark Wood, Jon Wesley,
Andy Rawlinson and Colin Straus

